



PRICES
TECHNICAL DATA
EQUIPMENT

IMPORTANT INFORMATION REGARDING THE SELECTION OF YOUR MOTORHOME

When buying a motorhome, camper van or urban vehicle (hereafter: motorhome), it is particularly important to choose the right layout and an appealing design. In addition, weight also plays an essential role. Family, friends, optional equipment, accessories and baggage – space must be available for all of these. At the same time, there are legal and technical limits to the configuration and load. Every motorhome is designed for a certain weight, which may not be exceeded during driving. For motorhome buyers, this raises the question: How should I configure my vehicle to accommodate passengers, baggage and accessories according to my needs without the vehicle exceeding this maximum weight? In order to make this decision easier for you, we provide you below with a few tips that are particularly important when selecting your vehicle from our portfolio:

1. THE TECHNICALLY PERMISSIBLE MAXIMUM LADEN MASS...

... is a value set by the manufacturer which the vehicle may not exceed. Carado specifies a layout-related upper limit for the vehicle, which can vary from layout to layout (e.g. 3,500 kg, 4,400 kg). You can find the corresponding specification for each layout in the technical data.

TYPE / MODEL	CV540 PRO	CV600 PRO
PERMITTED NUMBER OF SEATS (INCLUDING DRIVER)*		
BERTHS	/ + OPT	/ + OPT
Length / Width / Height (cm)	541 / 205 / 273	599 / 205 / 273
Headroom in living area (cm)	190	190
Standard chassis	Fiat Ducato	Fiat Ducato
Standard engine	2.2 Multijet	2.2 Multijet
kW (BHP)	103 (140)	103 (140)
Mass in running order (kg)*	2760 (2622 to 2898)*	2866 (2723 to 3009)*
Manufacturer-specified mass for optional equipment (kg)*	411	305
Technically permissible maximum laden mass (kg) *	3500	3500

2. THE MASS IN RUNNING ORDER...

... consists – to put it simply – of the basic vehicle with standard equipment plus a standard weight of 75 kg for the driver. It is legally permissible and possible for the mass in running order of your vehicle to deviate from the nominal value stated in the sales documents. The permissible tolerance is $\pm 5\%$. The permissible range in kilograms is given in brackets after the mass in running order. In order to provide you with full transparency regarding possible weight deviations, Carado weighs each vehicle at the end of the line and informs your trade partner of your vehicle's weighing result for forwarding to you.

Detailed explanations on the subject of mass in running order can be found in the “Legal Information” section.

3. THE PERMITTED NUMBER OF SEATS (INCLUDING DRIVER)...

... is determined by the manufacturer in what is referred to as the type-approval procedure. This results in what is referred to as the mass of the passengers. For this, a standard weight of 75 kg per passenger (without driver) is calculated. Detailed explanations on the subject of mass of the passengers can be found in the “Legal Information” section.

TYPE / MODEL	CV540 PRO	CV600 PRO
PERMITTED NUMBER OF SEATS (INCLUDING DRIVER)*		
BERTHS	/ + OPT	/ + OPT
Length / Width / Height (cm)	541 / 205 / 273	599 / 205 / 273
Headroom in living area (cm)	190	190
Standard chassis	Fiat Ducato	Fiat Ducato
Standard engine	2.2 Multijet	2.2 Multijet
kW (BHP)	103 (140)	103 (140)
Mass in running order (kg)*	2760 (2622 to 2898)*	2866 (2723 to 3009)*
Manufacturer-specified mass for optional equipment (kg)*	411	305
Technically permissible maximum laden mass (kg) *	3500	3500

4. THE MANUFACTURER-SPECIFIED MASS FOR OPTIONAL EQUIPMENT...

... is a value set by Carado per layout for the maximum mass of optional equipment that can be ordered. This limit is intended to ensure that the minimum pay-mass, i.e. the legally prescribed free mass for baggage and retrofitted accessories, is actually available for the vehicle load capacity of the vehicles delivered by Carado. If, in exceptional cases, the weighing at the end of the line nevertheless shows that the actual load capacity falls short of the minimum pay-mass due to a permissible weight deviation, we will check together with your trade partner and you whether we should, for example, increase the load capacity of the vehicle, reduce the number of seats or remove optional equipment before delivering the vehicle.

Detailed explanations on the subject of the effects of the tolerances on the minimum pay-mass and the payload can be found in the “Legal Information” section.

OPTIONAL EXTRAS



CONVERSION

Insulated waste water tank

ADDITIONAL WEIGHT*

5 kg

BASIC PACK + 32.4 kg*

Roof light over lounge area 70 x 50 cm

Shower equipment (extendable shower)

Window in bathroom

5. THE ADDITIONAL WEIGHT OF OPTIONAL EQUIPMENT AND PACKAGES...

... increases the actual mass of the vehicle (= mass in running order plus selected optional equipment) and reduces the pay-mass. The specified value shows the additional weight compared to the standard equipment of the respective layout. The total weight of the selected packages and optional equipment must not exceed the manufacturer-specified mass for optional equipment.

CAMPER VAN MODEL OVERVIEW

CV540



CV600



CV640

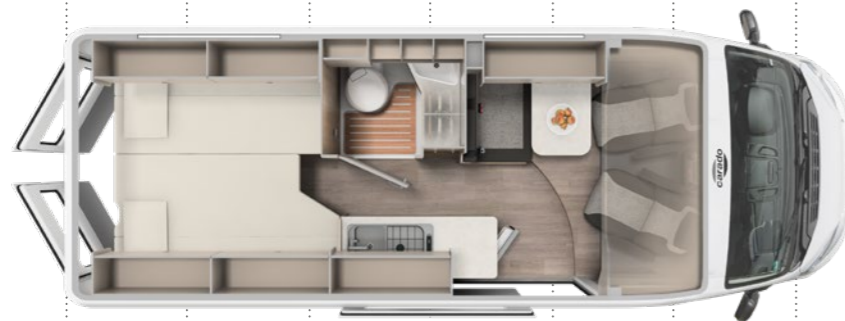

0 1 2 3 4 5 6 7m

TYPE / MODEL	CV540	CV600	CV640
BASIC PRICE INCL. VAT £	55,690.-	53,690.-	55,590.-
PERMITTED NUMBER OF SEATS (INCLUDING DRIVER)*	👤👤👤	👤👤👤	👤👤👤
BERTHS	👤👤 / + 👤 OPT	👤👤 / + 👤 OPT	👤👤 / + 👤 OPT
Length Width Height (cm)	541 / 205 / 261	599 / 205 / 258	636 / 205 / 258
Headroom in living area (cm)	190	190	190
Chassis	Peugeot Boxer	Peugeot Boxer	Peugeot Boxer
Standard engine	2.2 Blue HDi	2.2 Blue HDi	2.2 Blue HDi
kW (BHP)	103 (140)	103 (140)	103 (140)
Mass in running order (kg)*	2711 (2575 to 2847)*	2751 (2613 to 2889)*	2836 (2694 to 2978)*
Manufacturer-specified mass for optional equipment (kg)*	444	402	310
Technically permissible maximum laden mass (kg) *	3500	3500	3500
Trailer load braked (unbraked) (kg)	2500 (750)	2500 (750)	2500 (750)
Tyre size	215/75 R 16 C	215/70 R 15 CP	215/70 R 15 CP
Wheelbase (cm)	345	404	404
Bed dimension middle L x B (cm)	185 x 87 - 63 OPT	185 x 105 - 88 OPT	185 x 105 - 88 OPT
Bed dimension rear L x B (cm)	195 x 133 - 130	197 x 157 - 150	192 x 108 - 55 184 x 86
Refrigerator volume incl. freezer (l)	84	84	84
Heating type	Combi 4 Gas	Combi 4 Gas	Combi 4 Gas
Fresh water tank capacity total / at driving filling (l)	100 / 20 ¹⁾	100 / 20 ¹⁾	100 / 20 ¹⁾
Waste water tank (l)	90	90	90
Sockets 230 V	3	3	3
Sockets: USB	2	2	2
Gas bottle storage (filling weight in kg)	2 x 11	2 x 11	2 x 11

Configure
your dream
vehicle



OPT Optional ● Standard equipment — Not possible ▲ Not known at the time of publication

⚖️ * INFO

The specified mass in running order is a default value defined in the type-approval procedure. Due to manufacturing tolerances, the actual weighed mass in running order may deviate from the value stated above. Deviations of up to ± 5 % of the mass in running order are legally permissible and possible. The permissible range in kilograms is given in brackets after the mass in running order. The manufacturer-specified mass for optional equipment is a calculated value for each type and layout that Carado uses to determine the maximum weight available for factory-fitted optional equipment. The limitation of optional equipment is intended to ensure that the minimum pay-mass, i.e. the legally prescribed free mass for baggage and retrofitted accessories, is actually available for the vehicle load capacity of the vehicles delivered by Carado. The real weight of your vehicle ex works can only be determined when it is weighed at the

end of the line. If, in exceptional cases, the weighing shows that the actual load capacity falls below the minimum pay-mass despite limiting the optional equipment due to a permissible weight deviation, we will check together with your trade partner and you whether we should, for example, increase the load capacity of the vehicle, reduce the number of seats or remove optional equipment before delivering the vehicle. The technically permissible maximum laden mass of the vehicle and the technically permissible maximum mass on the axle must not be exceeded. Detailed information & explanations on the subject of weight and the configuration of the vehicle can be found in the section Legal information. For a more detailed description of all mandatory technical dependencies, please refer to the explanations on the footnotes.

CAMPER VAN

STANDARD EQUIPMENT



CHASSIS / BASE VEHICLE

- Peugeot Boxer 3.500 kg | 2.2 BlueHDi | 103 kW | 140 BHP | Euro 6 | 6-speed manual gearbox
- Peugeot Boxer 3.500 kg | 2.2 BlueHDi | 103 kW | 140 BHP Euro 6 | 8-speed automatic gearbox ²⁾
- Citroen white
- Front wheel drive
- Electric and heated mirrors
- Radio aerial integrated in mirror
- ABS | EBD | ESP incl. ABS and Hillholder
- Driver and Passenger airbag
- Cruise control
- Manual cab air conditioning
- Electric operated cab windows and central locking
- On-board computer incl. exterior temperature display
- Start & stop function incl. charge booster
- Disc brakes | rear and front wheel stabilisers | heat convection | tachometer | power steering | height-adjustable headlights | immobiliser | lap and diagonal seat belts
- 60 l fuel tank
- ESC Setup incl. Traction+
- 15" steel rims
- 16" steel rims ³⁾
- Tyres M+S Camping (snowflake)
- Fix & Go breakdown kit
- Headlights with black frame
- Multifunction steering wheel
- Radio pre-wiring including speakers
- Central cup holder
- USB charger (A+C)
- Driver and passenger seat with lumbar support
- Driver and passenger seats with armrests & upholstered covers
- Height and tilt adjustable driver and front passenger seats
- Driver and passenger seats swivel



EXTERIOR SETUP

- 7-year water ingress warranty ⁴⁾
- Double glazed hinged windows with cassette blinds and fly screens (siting area, kitchen)
- Rear hinged window (incl. blackout blind and flyscreen)
- Both rear doors with hinged window (incl. roller blind)
- Roof light 40 x 40 cm over lounging area with fly screen and blinds
- Roof light 40 x 40 cm over bedroom with fly screen and blinds
- Rear storage space with 4 integrated lashing rings
- Flyscreen door



COMFORT

- Isofix for 2 seats
- Bulkhead incl. step for rear double bed
- Pedestal in lounging area with integrated storage compartment
- Half dinette with integrated storage compartment
- Rear bed with partly slatted frame
- High quality mattresses with integrated GOODSITE for better sleeping comfort
- Ergonomically shaped upholstery for improved seating comfort
- Textile cab blinds
- Easy to position spotlight in light rail
- Spacious storage compartments and storage options
- Storage space in rear and sliding doors
- Spacious wardrobe (except CV540)
- Furniture in 'Visby Oak' and 'Sand grey'
- Floor Calais



INSTALLATIONS

- Flexible light strip
- Illuminated pedestal in lounging area
- Individually adjustable LED spotlights
- High-performance, maintenance-free leisure battery (95 Ah AGM)
- On-board control panel supplies information about filling levels and battery capacity
- Electric charger for leisure and vehicle battery 12 V / 18 A
- CEE 230 V external socket with safety device
- Sockets 3 x 230V | 1 x USB (double)
- Fresh water tank capacity total 100 l | waste water tank 90 l



HEATING / GAS SUPPLY

- Gas bottle locker for 2 x 11 kg gas bottles
- Gas heating Combi 4
- Gas control valves easily accessible and centrally arranged



EQUIPEMENT KITCHEN

- Ergonomically arranged kitchen with spacious work top
- Large soft-close drawers in kitchen
- 2 burner gas cooker with electric ignition and glass cover
- Worktop behind cooker (except CV540)
- Compressor fridge 84 l
- LED light tube
- Suspension bar (except CV540)



BATHROOM EQUIPMENT

- Fixed washbasin
- Spacious storage area
- Cassette toilet C 223
- Flush fitting LED spotlights
- Roof light with fly screen



SOFT FURNISHING

- Soft furnishing in black



EXTERIOR COLOUR

- Citroen white

CAMPER VAN PACKS

BASIC PACK + 31.4 kg*

Roof light over lounge area 70 x 50 cm	
Shower equipment	
Window in bathroom	
Clothes rail in bathroom	
Wide entrance step	
Rotating plate for table extension in seating area	

PACKAGE PRICE (£) **810.-**

OPTIC PACK 1 | PAINTED BUMPERS + 3 kg*

Painted bumper	
Black glossy skid plate	
Fog lights	

PACKAGE PRICE (£) **480.-**

OPTIC PACK 2 | ALLOY WHEELS + 8 kg*

Leather steering wheel and gear knob in leather trim	
Instrument panel with applications (Techno-Trim)	
16" alloy wheels two-colour	

PACKAGE PRICE (£) **1,080.-**

▲ Not known at the time of publication



* INFO

The factory installation of optional equipment increases the actual mass of the vehicle and reduces the pay-mass. The additional weight indicated for packages and optional equipment shows the additional weight compared to the standard equipment of the respective model or layout. The total weight of the selected optional equipment must not exceed the manufacturer-specified mass for optional equipment

shown in the model overviews. This is a calculated value for each type and layout that Carado uses to determine the maximum weight available for factory-fitted optional equipment. Detailed information and explanations on the subject of weight can be found in the Legal information section.

CARADO ORIGINAL ACCESSORIES*

BACKRACK+ MORE SPACE AND ORDER!



Innovative. Individual. Modular. The Carado Backrack+ with its different components opens up a new world of transportation and makes your Campervan something special. Whether you have bicycles, e-bikes, a spare wheel or transport a practical aluminum box, the right component can be mounted on the Backrack+ quickly and easily. Other components are already being developed and the versatility of the system continuously expanded. The Carado Backrack+ sets new standards in design and function.

BACKRACK+



ARTICLE	SUITABLE FOR SERIES	ART.-NR.	WEIGHT*	PAYLOAD
Backrack+ left	Camper Vans on Fiat Ducato and Citroen-Jumper-Basis	8502073	8,6 kg	80 kg
Backrack+ right	Camper Vans on Fiat Ducato and Citroen-Jumper-Basis	8502074	8,6 kg	80 kg

BIKE CARRIER SHUTTLE



ARTICLE	SUITABLE FOR SERIES	ART.-NR.	WEIGHT*	PAYLOAD
Backrack+ Bike Carrier Shuttle	Camper Vans on Fiat Ducato and Citroen-Jumper-Basis	8502212	5,4 kg pro bike carrier shuttle	28 kg pro holding arm

MINI RACK



ARTICLE	SUITABLE FOR SERIES	ART.-NR.	WEIGHT*	PAYLOAD
Backrack+ Mini Rack	Camper Vans on Fiat Ducato and Citroen-Jumper-Basis	8502213	4,5 kg	20 kg

WHEEL HOLDER

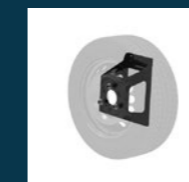

ARTICLE	SUITABLE FOR SERIES	ART.-NR.	WEIGHT*	PAYLOAD
Backrack+ Wheel Holder (Light-Chassis)	Camper Vans on Fiat Ducato and Citroen-Jumper-Basis	8502214	2,5 kg	35 kg
Backrack+ Wheel Holder (Maxi-Chassis)	Camper Vans on Fiat Ducato and Citroen-Jumper-Basis	8502215	2,5 kg	35 kg

NUMBER AND LIGHT BAR



ARTICLE	SUITABLE FOR SERIES	ART.-NR.	WEIGHT*	PAYLOAD
Number and Light Bar (implementation ≤ 6 m)	Camper Vans on Fiat Ducato and Citroen-Jumper-Basis	8502231	15,8 kg	100 kg
Number and Light Bar (implementation > 6 m)	Camper Vans on Fiat Ducato and Citroen-Jumper-Basis	8502232	15,8 kg	100 kg

carado-original-zubehoer.com/en









INFO

* The items listed in this category are Carado original parts and accessories that are Delivered ex works and not subsequently fitted to the vehicle under the responsibility of the manufacturer become. Original Carado parts and accessories that are subsequently attached to the vehicle affect the payload option and the axle loads. Please note that the technically permissible total mass of the vehicle and the technically permissible total mass on the axle even after the attachment of the original Carado parts and accessories may be exceeded. Further information and explanations on the weight issue can be found in the sales documents and on the manufacturers' website.



CAMPER VAN

OPTIONAL EQUIPMENT

OPTIONAL EXTRAS	PRICE ^{A)}	ADDITIONAL WEIGHT*
 PACKS		
Basic Pack ⁵⁾	£810.-	31.4 kg
Optic Pack 1 Painted bumpers	£480.-	3 kg
Optic Pack 2 Alloy wheels	£1,080.-	8 kg
 CHASSIS / BASE VEHICLE		
90 l fuel tank	£40.-	23 kg
 EXTERIOR SETUP		
Insulated and heated waste water tank	£540.-	10.5 kg
Bike rack for 2 bikes (black)	£490.-	10 kg
 COMFORT		
Bed conversion for lounging area (transversal guest bed)	£310.-	5 kg
Wooden duckboard for the shower tray	£80.-	2 kg
Folding Cab Blinds	£590.-	8 kg
 INSTALLATIONS		
Second AGM leisure battery 95 Ah	£300.-	27 kg
Heating Combi 6 E (with el. heating element) incl. digital control panel	£640.-	2 kg
Pre-cabling for reversing camera	£150.-	1 kg
Pre-cabling for solar panel	£150.-	2 kg
TV pre-cabling / TV holder	£200.-	3 kg
USB-port in the light rail	£50.-	0 kg
 SOFT FURNISHING		
Soft furnishing in white	£200.-	0 kg

	CV540	CV600	CV640
Basic Pack ⁵⁾	○	○	○
Optic Pack 1 Painted bumpers	○	○	○
Optic Pack 2 Alloy wheels	○	○	○
90 l fuel tank	○	○	○
Insulated and heated waste water tank	○	○	○
Bike rack for 2 bikes (black)	○	○	○
Bed conversion for lounging area (transversal guest bed)	○	○	○
Wooden duckboard for the shower tray	○	○	○
Folding Cab Blinds	○	○	○
Second AGM leisure battery 95 Ah	○	○	○
Heating Combi 6 E (with el. heating element) incl. digital control panel	○	○	○
Pre-cabling for reversing camera	○	○	○
Pre-cabling for solar panel	○	○	○
TV pre-cabling / TV holder	○	○	○
USB-port in the light rail	○	○	○
Soft furnishing in white	○	○	○

Available in package
 ● Standard equipment
 ○ Optional equipment
 ▲ Mandatory
 ─ Not possible
 ▲ Not known at the time of publication
 Notes from page 84

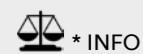

* INFO

The factory installation of optional equipment increases the actual mass of the vehicle and reduces the pay-mass. The additional weight indicated for packages and optional equipment shows the additional weight compared to the standard equipment of the respective model or layout. The total weight of the selected optional equipment must not exceed the manufacturer-specified mass for optional equipment

shown in the model overviews. This is a calculated value for each type and layout that Carado uses to determine the maximum weight available for factory-fitted optional equipment. Detailed information and explanations on the subject of weight can be found in the Legal information section.

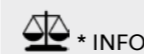

* INFO

The factory installation of optional equipment increases the actual mass of the vehicle and reduces the pay-mass. The additional weight indicated for packages and optional equipment shows the additional weight compared to the standard equipment of the respective model or layout. The total weight of the selected optional equipment must not exceed the manufacturer-specified mass for optional equipment

shown in the model overviews. This is a calculated value for each type and layout that Carado uses to determine the maximum weight available for factory-fitted optional equipment. Detailed information and explanations on the subject of weight can be found in the Legal information section.

CAMPER VAN MODEL OVERVIEW

CV540 PRO



CV600 PRO

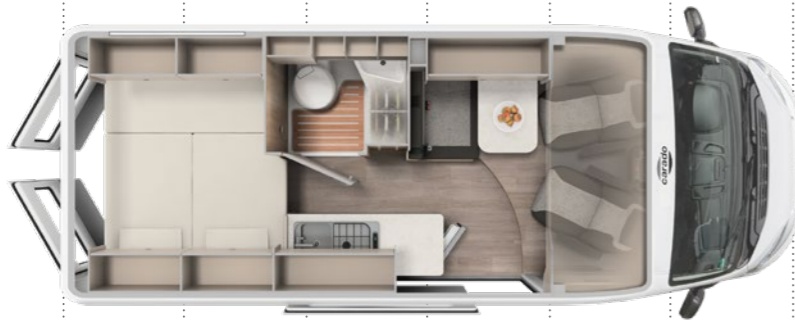

CV601 PRO



CV602 PRO



0 1 2 3 4 5 6 7m

TYPE / MODEL	CV540 PRO	CV600 PRO	CV601 PRO	CV602 PRO
BASIC PRICE INCL. VAT £	60,790.-	58,790.-	59,890.-	59,090.-
PERMITTED NUMBER OF SEATS (INCLUDING DRIVER)*	4	4	4	4
BERTHS	2 / + 2 OPT	2 / + 2 OPT	2 / + 2 OPT	2 / + 2 OPT
Length Width Height (cm)	541 / 205 / 261	599 / 205 / 261	599 / 205 / 261	599 / 205 / 261
Headroom in living area (cm)	190	190	190	190
Chassis	Fiat Ducato	Fiat Ducato	Fiat Ducato	Fiat Ducato
Standard engine	2.2 Multijet	2.2 Multijet	2.2 Multijet	2.2 Multijet
kW (BHP)	103 (140)	103 (140)	103 (140)	103 (140)
Mass in running order (kg)*	2748 (2611 to 2885)*	2851 (2708 to 2994)*	2891 (2746 to 3036)*	2829 (2688 to 2970)*
Manufacturer-specified mass for optional equipment (kg)*	407	302	264	324
Technically permissible maximum laden mass (kg) *	3500	3500	3500	3500
Trailer load braked (unbraked) (kg)	2500 (750)	2500 (750)	2500 (750)	2500 (750)
Tyre size	225/75 R 16 C	225/75 R 16 C	225/75 R 16 C	225/75 R 16 C
Wheelbase (cm)	345	404	404	404
Bed dimension: pop-top roof (cm)	206 x 143 OPT	206 x 143 OPT	206 x 143 OPT	206 x 143 OPT
Bed dimension middle L x B (cm)	185 x 87 - 63 OPT	185 x 105 - 88 OPT	185 x 105 - 88 OPT	185 x 105 - 88 OPT
Bed dimension rear L x B (cm)	195 x 133 - 130	197 x 157 - 150	185 x 157 - 150 187 x 130	190 x 108 - 56 187 x 86
Refrigerator volume incl. freezer (l)	84	84	84	84
Heating type	Combi 4 Gas	Combi 4 Gas	Combi 4 D Diesel	Combi 4 Gas
Fresh water tank capacity total / at driving filling (l)	100 / 20 ¹⁾	100 / 20 ¹⁾	100 / 20 ¹⁾	100 / 20 ¹⁾
Waste water tank (l)	90	90	90	90
Sockets 230 V	3	3	3	3
Sockets: USB	2	2	2	2
Gas bottle storage (filling weight in kg)	2 x 11	2 x 11	2 x 5	2 x 11

OPT Optional ● Standard equipment — Not possible ▲ Not known at the time of publication

* INFO

The specified mass in running order is a default value defined in the type-approval procedure. Due to manufacturing tolerances, the actual weighed mass in running order may deviate from the value stated above. Deviations of up to ± 5 % of the mass in running order are legally permissible and possible. The permissible range in kilograms is given in brackets after the mass in running order. The manufacturer-specified mass for optional equipment is a calculated value for each type and layout that Carado uses to determine the maximum weight available for factory-fitted optional equipment. The limitation of optional equipment is intended to ensure that the minimum pay-mass, i.e. the legally prescribed free mass for baggage and retrofitted accessories, is actually available for the vehicle load capacity of the vehicles delivered by Carado. The real weight of your vehicle ex works can only be determined when it is weighed at the

end of the line. If, in exceptional cases, the weighing shows that the actual load capacity falls below the minimum pay-mass despite limiting the optional equipment due to a permissible weight deviation, we will check together with your trade partner and you whether we should, for example, increase the load capacity of the vehicle, reduce the number of seats or remove optional equipment before delivering the vehicle. The technically permissible maximum laden mass of the vehicle and the technically permissible maximum mass on the axle must not be exceeded. Detailed information & explanations on the subject of weight and the configuration of the vehicle can be found in the section Legal information. For a more detailed description of all mandatory technical dependencies, please refer to the explanations on the footnotes.

Configure
your dream
vehicle



CAMPER VAN MODEL OVERVIEW

CV640 PRO



CV600 PRO+



CV640 PRO+

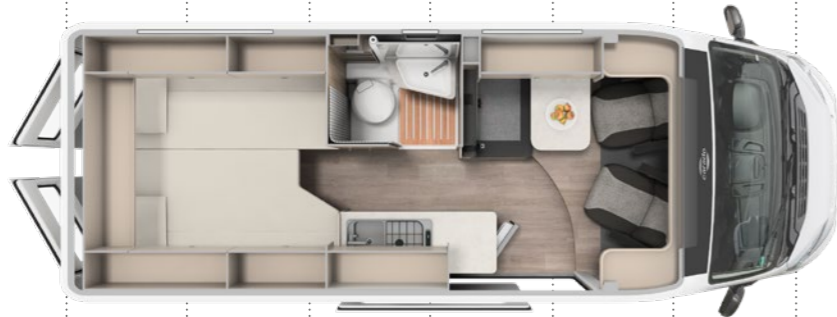

0 1 2 3 4 5 6 7m

TYPE / MODEL	CV640 PRO	CV600 PRO+	CV640 PRO+
BASIC PRICE INCL. VAT £	60,890.-	62,090.-	64,090.-
PERMITTED NUMBER OF SEATS (INCLUDING DRIVER)*	👤👤👤👤	👤👤👤	👤👤👤
BERTHS	👤👤 / + 👤👤 OPT	👤👤 / + 👤👤 OPT	👤👤 / + 👤👤 OPT
Length Width Height (cm)	636 / 205 / 261	599 / 205 / 261	636 / 205 / 261
Headroom in living area (cm)	190	190	190
Chassis	Fiat Ducato	Fiat Ducato	Fiat Ducato
Standard engine	2.2 Multijet	2.2 Multijet	2.2 Multijet
kW (BHP)	103 (140)	103 (140)	103 (140)
Mass in running order (kg)*	2939 (2792 to 3086)*	2856 (2713 to 2999)*	2944 (2797 to 3091)*
Manufacturer-specified mass for optional equipment (kg)*	207	297	202
Technically permissible maximum laden mass (kg) *	3500	3500	3500
Trailer load braked (unbraked) (kg)	2500 (750)	2500 (750)	2500 (750)
Tyre size	225/75 R 16 C	225/75 R 16 C	225/75 R 16 C
Wheelbase (cm)	404	404	404
Bed dimension: pop-top roof (cm)	206 x 143 OPT	206 x 143 OPT	206 x 143 OPT
Bed dimension middle L x B (cm)	185 x 105 - 88 OPT	185 x 105 - 88 OPT	185 x 105 - 88 OPT
Bed dimension rear L x B (cm)	192 x 108 - 55 184 x 86	197 x 157 - 150	192 x 108 - 55 184 x 86
Refrigerator volume incl. freezer (l)	84	84	84
Heating type	Combi 4 Gas	Combi 4 Gas	Combi 4 Gas
Fresh water tank capacity total / at driving filling (l)	100 / 20 ¹⁾	100 / 20 ¹⁾	100 / 20 ¹⁾
Waste water tank (l)	90	90	90
Sockets 230 V	3	3	3
Sockets: USB	2	2	2
Gas bottle storage (filling weight in kg)	2 x 11	2 x 11	2 x 11

Configure
your dream
vehicle



OPT Optional ● Standard equipment — Not possible ▲ Not known at the time of publication

⚖️ * INFO

The specified mass in running order is a default value defined in the type-approval procedure. Due to manufacturing tolerances, the actual weighed mass in running order may deviate from the value stated above. Deviations of up to ± 5 % of the mass in running order are legally permissible and possible. The permissible range in kilograms is given in brackets after the mass in running order. The manufacturer-specified mass for optional equipment is a calculated value for each type and layout that Carado uses to determine the maximum weight available for factory-fitted optional equipment. The limitation of optional equipment is intended to ensure that the minimum pay-mass, i.e. the legally prescribed free mass for baggage and retrofitted accessories, is actually available for the vehicle load capacity of the vehicles delivered by Carado. The real weight of your vehicle ex works can only be determined when it is weighed at the

end of the line. If, in exceptional cases, the weighing shows that the actual load capacity falls below the minimum pay-mass despite limiting the optional equipment due to a permissible weight deviation, we will check together with your trade partner and you whether we should, for example, increase the load capacity of the vehicle, reduce the number of seats or remove optional equipment before delivering the vehicle. The technically permissible maximum laden mass of the vehicle and the technically permissible maximum mass on the axle must not be exceeded. Detailed information & explanations on the subject of weight and the configuration of the vehicle can be found in the section Legal information. For a more detailed description of all mandatory technical dependencies, please refer to the explanations on the footnotes.

CAMPER VAN STANDARD EQUIPMENT



PACKS

- Basic Pack ⁵⁾
- Optic Pack 1 | Painted bumpers
- Optic Pack 2 | Alloy wheels
- pro Pack CV540 ²⁾
- pro Pack CV600 & CV601 & CV602
- pro Pack CV640
- pro+ Pack CV600 pro+
- pro+ Pack CV640 pro+



CHASSIS / BASE VEHICLE

- Fiat Ducato 3.500 kg | 2.2 Multijet | 103 kW | 140 BHP Euro 6 | 6-speed manual gearbox
- Cruise control
- ABS | EBD | ESP incl. ABS and Hillholder
- ESC Setup
- Traction+
- Start & Stop function incl. charge booster
- Driver airbag
- Passenger airbag
- Manual cab air conditioning
- Electric operated cab windows and central locking
- Radio pre-wiring including speakers
- On-board computer incl. exterior temperature display
- USB charger (A+C)
- Multifunction steering wheel
- Central cup holder
- Radio aerial integrated in mirror
- Fix & Go breakdown kit
- Front wheel drive
- Disc brakes | rear and front wheel stabilisers | heat convection | tachometer | power steering, height-adjustable headlights | immobiliser | lap and diagonal seat belts
- Tyres M+S Camping (snowflake)
- Headlights with black frame
- Daytime running lights integrated in headlights
- Driver and passenger seats in matching colours
- Captain chairs with covers
- Height and tilt adjustable driver and front passenger seats
- Swiveling driver and passenger seats
- Driver and passenger seat with lumbar support



EXTERIOR SETUP

- 7-year water ingress warranty ⁴⁾
- Double glazed hinged windows with cassette blinds and fly screens (siting area, kitchen)
- Rear hinged window (incl. blackout blind and flyscreen)
- Both rear doors with hinged window (incl. roller blind)
- Roof light 40 x 40 cm over lounging area with fly screen and blinds
- Roof light 40 x 40 cm over bedroom with fly screen and blinds
- Rear storage space with 4 integrated lashing rings
- Flyscreen door



COMFORT

- Isofix for 2 seats
- Bulkhead incl. step for rear double bed
- Pedestal in lounging area with integrated storage compartment
- Half dinette with integrated storage compartment
- Rear bed with partly slatted frame
- High quality mattresses with integrated GOODSITE for better sleeping comfort
- Ergonomically shaped upholstery for improved seating comfort
- Easy to position spotlight in light bar (except CV601)
- Spacious storage compartments and storage options
- Storage space in rear and sliding doors
- Spacious wardrobe (except CV540 and CV602)
- Furniture in 'Visby Oak' and 'Sand grey'
- Floor Calais
- Folding Cab Blinds



INSTALLATIONS

- Flexible light strip
- Illuminated pedestal in lounging area
- Individually adjustable LED spotlights
- High-performance, maintenance-free leisure battery (95 Ah AGM)
- On-board control panel supplies information about filling levels and battery capacity
- Electric charger for leisure and vehicle battery 12 V / 18 A
- CEE 230 V external socket with safety device
- Sockets 3 x 230V | 1 x USB (double)
- Fresh water tank capacity total 100 l | waste water tank 90 l



HEATING / GAS SUPPLY

- Gas bottle locker for 2 x 11 kg gas bottles (except CV601 with 2 x 5 kg bottles)
- Gas heating Combi 4
- Diesel heating Combi 4
- Gas control valves easily accessible and centrally arranged



EQUIPEMENT KITCHEN

- Ergonomically arranged kitchen with spacious work top
- Large soft-close drawers in kitchen
- 2 burner gas cooker with electric ignition and glass cover
- Worktop behind cooker (except CV540 and CV602)
- Compressor fridge 84 l
- LED light tube
- Suspension bar (except CV540 and CV602)



BATHROOM EQUIPMENT

- Swivelling bath (CV600 pro+ and CV640 pro+)
- Fixed washbasin
- Spacious storage area
- Cassette toilet C 223
- Flush fitting LED spotlights
- Roof light with fly screen



SOFT FURNISHING

- Soft furnishing in white



EXTERIOR COLOUR

- Chassis colour white

CAMPER VAN PACKS

BASIC PACK + 31.4 kg*

Roof light over lounge area 70 x 50 cm

Shower equipment

Window in bathroom

Clothes rail in bathroom

Wide entrance step

Rotating plate for table extension in seating area

INCLUDED AS STANDARD

CHASSIS PACK -8.3 kg*

Electrically folding door mirrors

Parking sensors

Blind spot assistant

Electric parking brake

PACKAGE PRICE (£)

1,640.-

DIGITAL PACK + 4 kg*

Automatic cab air conditioning with pollen filter

Wireless smartphone charging

10" radio and navigation system (DAB+)

7" digital TFT color display

Rear view camera with dynamic grid lines

PACKAGE PRICE (£)

2,910.-



* INFO

The factory installation of optional equipment increases the actual mass of the vehicle and reduces the pay-mass. The additional weight indicated for packages and optional equipment shows the additional weight compared to the standard equipment of the respective model or layout. The total weight of the selected optional equipment must not exceed the manufacturer-specified mass for optional equipment

shown in the model overviews. This is a calculated value for each type and layout that Carado uses to determine the maximum weight available for factory-fitted optional equipment. Detailed information and explanations on the subject of weight can be found in the Legal information section.

SAFETY PACK INCL. ACC + 0 kg*

Automatic braking system with pedestrian detection

Rain and light sensor

Lane assist

Traffic sign recognition

Fatigue detection

Intelligent speed detection

Adaptive cruise control >30 km/h

PACKAGE PRICE (£)

1,520.-

CO-DRIVER PACK + 0.3 kg*

ACC with stop & go

Lane centering

Traffic jam assist

INCLUDED AS STANDARD

OPTIC PACK 1 | PAINTED BUMPERS + 3 kg*

Painted bumper

Black glossy skid plate

Fog lights

INCLUDED AS STANDARD

OPTIC PACK 2 | ALLOY WHEELS + 8 kg*

Leather steering wheel and gear knob in leather trim

Instrument panel with applications (Techno-Trim)

16" alloy wheels two-colour

INCLUDED AS STANDARD

▲ Not known at the time of publication



* INFO

The factory installation of optional equipment increases the actual mass of the vehicle and reduces the pay-mass. The additional weight indicated for packages and optional equipment shows the additional weight compared to the standard equipment of the respective model or layout. The total weight of the selected optional equipment must not exceed the manufacturer-specified mass for optional equipment

shown in the model overviews. This is a calculated value for each type and layout that Carado uses to determine the maximum weight available for factory-fitted optional equipment. Detailed information and explanations on the subject of weight can be found in the Legal information section.

PRO PACK CV540 + 97 kg*

Optic Pack 1 Painted bumpers	
Optic Pack 2 Alloy wheels	
Basic Pack	
90 l fuel tank	
Folding Cab Blinds	
Awning 3.25 m (black)	
pro decals	

INCLUDED AS STANDARD

PRO PACK CV600 & CV601 & CV602 + 100 kg*

Optic Pack 1 Painted bumpers	
Optic Pack 2 Alloy wheels	
Basic Pack	
90 l fuel tank	
Folding Cab Blinds	
Awning 3.75 m (black)	
pro decals	

INCLUDED AS STANDARD

PRO PACK CV640 + 103 kg*

Optic Pack 1 Painted bumpers	
Optic Pack 2 Alloy wheels	
Basic Pack	
90 l fuel tank	
Folding Cab Blinds	
Awning 4 m (black)	
pro decals	

INCLUDED AS STANDARD

PRO+ PACK CV600 PRO+ + 105 kg*

Optic Pack 1 Painted bumpers	
Optic Pack 2 Alloy wheels	
Basic Pack	
90 l fuel tank	
Folding Cab Blinds	
Framed windows	
Awning 3.75 m (black)	
pro+ decals	
LED lighting integrated above the roof cabinets	
Panoramic window above driver's and passenger seat	
Wraparound overhead cabinet in rear	

INCLUDED AS STANDARD

PRO+ PACK CV640 PRO+ + 108 kg*

Optic Pack 1 Painted bumpers	
Optic Pack 2 Alloy wheels	
Basic Pack	
90 l fuel tank	
Folding Cab Blinds	
Framed windows	
Awning 4 m (black)	
pro+ decals	
LED lighting integrated above the roof cabinets	
Panoramic window above driver's and passenger seat	
Wraparound overhead cabinet in rear	

INCLUDED AS STANDARD

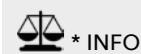

* INFO

The factory installation of optional equipment increases the actual mass of the vehicle and reduces the pay-mass. The additional weight indicated for packages and optional equipment shows the additional weight compared to the standard equipment of the respective model or layout. The total weight of the selected optional equipment must not exceed the manufacturer-specified mass for optional equipment

shown in the model overviews. This is a calculated value for each type and layout that Carado uses to determine the maximum weight available for factory-fitted optional equipment. Detailed information and explanations on the subject of weight can be found in the Legal information section.

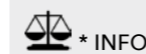

* INFO

The factory installation of optional equipment increases the actual mass of the vehicle and reduces the pay-mass. The additional weight indicated for packages and optional equipment shows the additional weight compared to the standard equipment of the respective model or layout. The total weight of the selected optional equipment must not exceed the manufacturer-specified mass for optional equipment

shown in the model overviews. This is a calculated value for each type and layout that Carado uses to determine the maximum weight available for factory-fitted optional equipment. Detailed information and explanations on the subject of weight can be found in the Legal information section.

▲ Not known at the time of publication

CAMPER VAN

OPTIONAL EQUIPMENT

OPTIONAL EXTRAS PRICE ^{A)} ADDITIONAL WEIGHT*



PACKS

OPTIONAL EXTRAS	PRICE ^{A)}	ADDITIONAL WEIGHT*
Chassis Pack	£1,640.-	-8.3 kg
Digital Pack	£2,910.-	4 kg
Safety Pack incl. ACC	£1,520.-	0 kg
Co-Driver Pack ⁶⁾	£2,120.-	0.3 kg



CHASSIS / BASE VEHICLE

Fiat Ducato 3.500 kg 2.2 Multijet 103 kW 140 BHP Euro 6 8-speed automatic gearbox ²⁾	£2,870.-	60 kg
Tyre pressure indicator	£260.-	0 kg
Fully LED headlights including indicators and LED daytime running lights	£990.-	0 kg
Electrical preparation for trailer coupling	£330.-	0 kg
Spare wheel incl. holder and car jack instead of Fix & Go kit	£270.-	30 kg



EXTERIOR SETUP

Black pop-top roof ⁷⁾	£5,120.-	152 kg
Insulated and heated waste water tank	£540.-	10.5 kg
Bike rack for 2 bikes (black)	£490.-	10 kg
Framed windows	£590.-	5 kg

CV540 PRO CV600 PRO CV601 PRO CV602 PRO CV640 PRO CV600 PRO+ CV640 PRO+

○	○	○	○	○	○	○
○	○	○	○	○	○	○
○	○	○	○	○	○	○
○	○	○	○	○	○	○

●	○	○	○	○	○	○
○	○	○	○	○	○	○
○	○	○	○	○	○	○
○	○	○	○	○	○	○
○	○	○	○	○	○	○

○	○	○	○	○	○	○
○	○	○	○	○	○	○
○	○	○	○	○	○	○
○	○	○	○	○	●	●

□ Available in package ● Standard equipment ○ Optional equipment ▲ Mandatory — Not possible ▲ Not known at the time of publication Notes from page 84



* INFO

The factory installation of optional equipment increases the actual mass of the vehicle and reduces the pay-mass. The additional weight indicated for packages and optional equipment shows the additional weight compared to the standard equipment of the respective model or layout. The total weight of the selected optional equipment must not exceed the manufacturer-specified mass for optional equipment

shown in the model overviews. This is a calculated value for each type and layout that Carado uses to determine the maximum weight available for factory-fitted optional equipment. Detailed information and explanations on the subject of weight can be found in the Legal information section.





* INFO

The factory installation of optional equipment increases the actual mass of the vehicle and reduces the pay-mass. The additional weight indicated for packages and optional equipment shows the additional weight compared to the standard equipment of the respective model or layout. The total weight of the selected optional equipment must not exceed the manufacturer-specified mass for optional equipment

shown in the model overviews. This is a calculated value for each type and layout that Carado uses to determine the maximum weight available for factory-fitted optional equipment. Detailed information and explanations on the subject of weight can be found in the Legal information section.

OPTIONAL EXTRAS PRICE ^{A)} ADDITIONAL WEIGHT*

 COMFORT		
Bed conversion for lounging area (transversal guest bed)	£310.-	5 kg
Wooden duckboard for the shower tray	£80.-	2 kg

 INSTALLATIONS		
Caramatic SafeDrive PLUS (two-bottle system with gas pressure regulator and crash sensor)	£270.-	3.5 kg
Second AGM leisure battery 95 Ah	£300.-	27 kg
Heating Combi 6 E (with el. heating element) incl. digital control panel	£640.-	2 kg
Diesel heating Combi 4 incl. integrated altitude pressure sensor and digital control panel ⁸⁾	£680.-	4.6 kg
Pre-cabling for reversing camera	£150.-	1 kg
Pre-cabling for solar panel ⁹⁾	£150.-	2 kg
TV pre-cabling / TV holder	£200.-	3 kg
USB-port in the light rail	£50.-	0 kg
Mobile internet (WiFi / LTE antenna incl. router) ¹⁰⁾	£900.-	1.42 kg

 EXTERIOR COLOUR		
Artense Grey metallic	£850.-	2.5 kg
Fer grey metallic	£850.-	2.5 kg
Campovolo	£710.-	0 kg
Lanzarote grey	£710.-	0 kg

	CV540 PRO	CV600 PRO	CV601 PRO	CV602 PRO	CV640 PRO	CV600 PRO+	CV640 PRO+
Bed conversion for lounging area (transversal guest bed)	○	○	○	○	○	○	○
Wooden duckboard for the shower tray	○	○	○	○	○	○	○
Caramatic SafeDrive PLUS (two-bottle system with gas pressure regulator and crash sensor)	○	○	—	○	○	○	○
Second AGM leisure battery 95 Ah	○	○	○	○	○	○	○
Heating Combi 6 E (with el. heating element) incl. digital control panel	○	○	—	○	○	○	○
Diesel heating Combi 4 incl. integrated altitude pressure sensor and digital control panel ⁸⁾	○	○	●	○	○	○	○
Pre-cabling for reversing camera	○	○	○	○	○	○	○
Pre-cabling for solar panel ⁹⁾	○	○	○	○	○	○	○
TV pre-cabling / TV holder	○	○	○	○	○	○	○
USB-port in the light rail	○	○	○	○	○	○	○
Mobile internet (WiFi / LTE antenna incl. router) ¹⁰⁾	○	○	○	○	○	○	○
Artense Grey metallic	○	○	○	○	○	○	○
Fer grey metallic	○	○	○	○	○	○	○
Campovolo	○	○	○	○	○	○	○
Lanzarote grey	○	○	○	○	○	○	○

□ Available in package ● Standard equipment ○ Optional equipment ▲ Mandatory — Not possible ▲ Not known at the time of publication Notes from page 84

 * INFO
 The factory installation of optional equipment increases the actual mass of the vehicle and reduces the pay-mass. The additional weight indicated for packages and optional equipment shows the additional weight compared to the standard equipment of the respective model or layout. The total weight of the selected optional equipment must not exceed the manufacturer-specified mass for optional equipment shown in the model overviews. This is a calculated value for each type and layout that Carado uses to determine the maximum weight available for factory-fitted optional equipment. Detailed information and explanations on the subject of weight can be found in the Legal information section.

 * INFO
 The factory installation of optional equipment increases the actual mass of the vehicle and reduces the pay-mass. The additional weight indicated for packages and optional equipment shows the additional weight compared to the standard equipment of the respective model or layout. The total weight of the selected optional equipment must not exceed the manufacturer-specified mass for optional equipment shown in the model overviews. This is a calculated value for each type and layout that Carado uses to determine the maximum weight available for factory-fitted optional equipment. Detailed information and explanations on the subject of weight can be found in the Legal information section.

VAN MODEL OVERVIEW

V132



V337

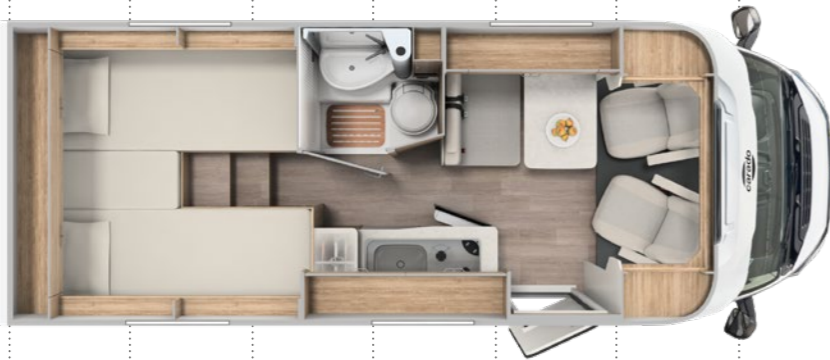

V339

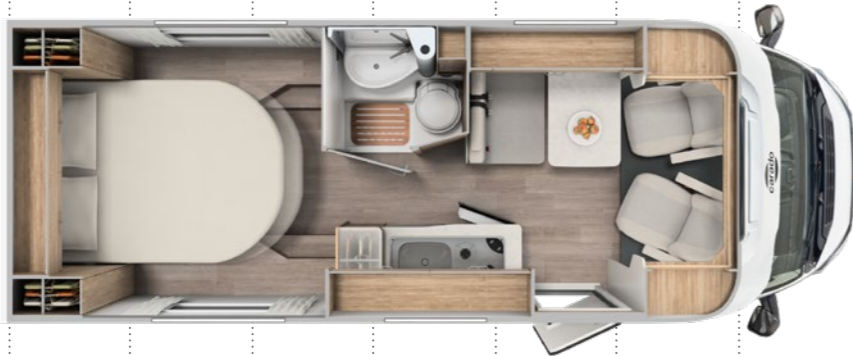

0 1 2 3 4 5 6 7m

TYPE / MODEL	V132	V337	V339
BASIC PRICE INCL. VAT £	55,290.-	57,790.-	57,990.-
PERMITTED NUMBER OF SEATS (INCLUDING DRIVER)*	👤👤👤	👤👤👤	👤👤👤
BERTHS	👤👤 / + 👤 OPT	👤👤	👤👤
Length Width Height (cm)	594 / 214 / 271	664 / 214 / 271	685 / 214 / 271
Headroom in living area (cm)	195	195	195
Chassis	Fiat Ducato	Fiat Ducato	Fiat Ducato
Standard engine	2.2 Multijet	2.2 Multijet	2.2 Multijet
kW (BHP)	103 (140)	103 (140)	103 (140)
Mass in running order (kg)*	2578 (2449 to 2707)*	2633 (2501 to 2765)*	2681 (2547 to 2815)*
Manufacturer-specified mass for optional equipment (kg)*	588	526	468
Technically permissible maximum laden mass (kg) *	3500	3500	3500
Trailer load braked (unbraked) (kg)	2000 (750)	2000 (750)	2000 (750)
Tyre size	215/70 R 15 CP	215/70 R 15 CP	215/70 R 15 CP
Wheelbase (cm)	345	380	380
Bed dimension middle L x B (cm)	192 x 65 - 45 OPT		
Bed dimension rear L x B (cm)	194 x 140 - 130	200 x 70 195 x 80 200 - 195 x 194 OPT	195 x 140
Refrigerator volume incl. freezer (l)	78 (11)	78 (11)	78 (11)
Heating type	Combi 4 Gas	Combi 4 Gas	Combi 4 Gas
Fresh water tank capacity total / at driving filling (l)	116 / 20 ¹⁾	116 / 20 ¹⁾	116 / 20 ¹⁾
Waste water tank (l)	92	92	92
Sockets 230 V	4	4	4
Sockets: USB	4	2	2
Inner dimensions storage locker right/left W x H (cm)	65 x 110 45 x 85 OPT	65 x 105 70 x 75 OPT	85 x 90 85 x 90
Gas bottle storage (filling weight in kg)	2 x 11	2 x 11	2 x 11

Configure
your dream
vehicle



OPT Optional ● Standard equipment — Not possible ▲ Not known at the time of publication

⚖️ * INFO

The specified mass in running order is a default value defined in the type-approval procedure. Due to manufacturing tolerances, the actual weighed mass in running order may deviate from the value stated above. Deviations of up to ± 5 % of the mass in running order are legally permissible and possible. The permissible range in kilograms is given in brackets after the mass in running order. The manufacturer-specified mass for optional equipment is a calculated value for each type and layout that Carado uses to determine the maximum weight available for factory-fitted optional equipment. The limitation of optional equipment is intended to ensure that the minimum pay-mass, i.e. the legally prescribed free mass for baggage and retrofitted accessories, is actually available for the vehicle load capacity of the vehicles delivered by Carado. The real weight of your vehicle ex works can only be determined when it is weighed at the

end of the line. If, in exceptional cases, the weighing shows that the actual load capacity falls below the minimum pay-mass despite limiting the optional equipment due to a permissible weight deviation, we will check together with your trade partner and you whether we should, for example, increase the load capacity of the vehicle, reduce the number of seats or remove optional equipment before delivering the vehicle. The technically permissible maximum laden mass of the vehicle and the technically permissible maximum mass on the axle must not be exceeded. Detailed information & explanations on the subject of weight and the configuration of the vehicle can be found in the section Legal information. For a more detailed description of all mandatory technical dependencies, please refer to the explanations on the footnotes.

MOTORHOME

STANDARD EQUIPMENT



CHASSIS / BASE VEHICLE

- Fiat Ducato 3.500 kg | 2.2 Multijet | 103 kW | 140 BHP Euro 6 | 6-speed manual gearbox
- Front wheel drive
- Driver airbag
- Passenger airbag
- ABS | EBD | ESP incl. ABS and Hillholder
- Comfortable driving experience with rear and front axle stabilizers
- Start & Stop function incl. charge booster
- Traction+
- Electric operated cab windows and central locking
- Central cup holder
- Manual cab air conditioning
- Multifunction steering wheel
- USB charger (A+C)
- Fix & Go breakdown kit
- Radio aerial integrated in mirror
- Daytime running lights integrated in headlights
- Headlights with black frame
- Electric and heated mirrors
- Disc brakes | heat convection | tachometer | power steering | immobiliser | 3-point seat belt
- 60 l fuel tank
- 15" steel rims
- Tyres M+S Camping (snowflake)
- Driver and passenger seat with lumbar support
- Height and tilt adjustable driver and front passenger seats
- Captain chairs with covers
- Driver and passenger seats swivel
- Driver and passenger seats with armrests & upholstered covers



EXTERIOR SETUP

- 7-year water ingress warranty ⁴⁾
- GRP (glass fibre reinforced plastic) roof and rear wall
- Aluminium sidewalls
- Roof and sidewall thickness 34 mm | floor thickness 42,5 mm
- Rear light carrier in three parts with integrated LED multifunction lights
- High quality entrance door with ergonomic handle inside and outside
- Electric entrance step
- Double glazed hinged window with cassette blinds and flyscreens (except for bathroom)
- Roof light with frosted perspex glass and flyscreen
- Large rear garage with lowered frame | lashing rings and interior lighting (depending on model)
- Splash water seals for the exterior storage locker and doors
- Payload in garage up to 150 kg



COMFORT

- Ergonomically shaped upholstery for improved seating comfort
- Isofix for 2 seats
- Table extension
- High-quality mattress in all beds
- Removable and washable mattress cover
- Wooden slatted frame in all fixed-beds for better sleeping comfort
- Spacious storage compartments and storage options
- Ventilation for storage locker and seat backrest
- Overhead lockers with softclose system
- Furniture in 'Visby Oak'
- Floor Calais



INSTALLATIONS

- High-performance, maintenance-free leisure battery (95 Ah AGM)
- On-board control panel supplies information about filling levels and battery capacity
- Automatic switching and separating systems for starter and leisure battery as well as for refrigerator
- Electric charger for leisure and vehicle battery 12 V / 18 A
- CEE 230 V external socket with safety device
- Residual Current Device (RCD)
- LED-Awning light
- LED Interior light
- USB Socket A/C
- Fresh water tank capacity total 116 l, waste water tank 92 l



HEATING / GAS SUPPLY

- Gas control valves easily accessible and centrally arranged
- Gas heating Combi 4
- Gas bottle locker for 2 x 11 kg gas bottles



EQUIPEMENT KITCHEN

- Ergonomically arranged kitchen with spacious work top
- Large soft-close drawers in kitchen
- 2 Burner gas cooker with piezo ignition and glass cover
- Fridge 78 l with 11 l freezer compartment
- Waste bin



BATHROOM EQUIPMENT

- Vario-bathroom
- Roof vent with integrated flyscreen blind
- Large mirrors
- Clothes rail in bathroom
- Shower cubicle lining



SOFT FURNISHING

- Soft furnishing in white



EXTERIOR COLOUR

- Chassis colour white

MOTORHOME PACKS

PRO+ PACK V132 + 83 kg*

Optic Pack 1 Painted bumpers	
Optic Pack 2 Alloy wheels	
Basic Pack	
Artense grey metallic	
Folding Cab Blinds	
Cab sunroof	
Special coloured overhead storage cupboard doors in cozy white	
pro+ decals	
Awning 3.5 m	
Insulated waste water tank	
2nd external storage door (size depends on layout)	

PACKAGE PRICE (£) **4,190.-**

PRO+ PACK V337 + 84 kg*

Optic Pack 1 Painted bumpers	
Optic Pack 2 Alloy wheels	
Basic Pack	
Artense grey metallic	
Folding Cab Blinds	
Cab sunroof	
Special coloured overhead storage cupboard doors in cozy white	
pro+ decals	
Awning 4 m	
Insulated waste water tank	
2nd external storage door (size depends on layout)	

PACKAGE PRICE (£) **4,280.-**

PRO+ PACK V339 + 81 kg*

Optic Pack 1 Painted bumpers	
Optic Pack 2 Alloy wheels	
Basic Pack	
Artense grey metallic	
Folding Cab Blinds	
Cab sunroof	
Special coloured overhead storage cupboard doors in cozy white	
pro+ decals	
Awning 4 m	
Insulated waste water tank	

PACKAGE PRICE (£) **4,280.-**

BASIC PACK + 14.6 kg*

Panoramic roof light 70 x 50 cm	
Clear glass roof light 40 x 40	
Mirror and coat hooks	
Bridge Light	
Flyscreen door (one-piece)	

PACKAGE PRICE (£) **570.-**

△ Not known at the time of publication

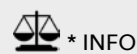

* INFO

The factory installation of optional equipment increases the actual mass of the vehicle and reduces the pay-mass. The additional weight indicated for packages and optional equipment shows the additional weight compared to the standard equipment of the respective model or layout. The total weight of the selected optional equipment must not exceed the manufacturer-specified mass for optional equipment

shown in the model overviews. This is a calculated value for each type and layout that Carado uses to determine the maximum weight available for factory-fitted optional equipment. Detailed information and explanations on the subject of weight can be found in the Legal information section.

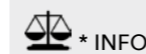

* INFO

The factory installation of optional equipment increases the actual mass of the vehicle and reduces the pay-mass. The additional weight indicated for packages and optional equipment shows the additional weight compared to the standard equipment of the respective model or layout. The total weight of the selected optional equipment must not exceed the manufacturer-specified mass for optional equipment

shown in the model overviews. This is a calculated value for each type and layout that Carado uses to determine the maximum weight available for factory-fitted optional equipment. Detailed information and explanations on the subject of weight can be found in the Legal information section.

OPTIC PACK 1 | PAINTED BUMPERS + 3 kg*

Painted bumper	
Black glossy skid plate	
Fog lights	

PACKAGE PRICE (£) **480.-**

OPTIC PACK 2 | ALLOY WHEELS + 8 kg*

Leather steering wheel and gear knob in leather trim	
Instrument panel with applications (Techno-Trim)	
16" alloy wheels two-colour	

PACKAGE PRICE (£) **1,080.-**

DIGITAL PACK + 4 kg*

Automatic cab air conditioning with pollen filter	
Wireless smartphone charging	
10" radio and navigation system (DAB+)	
7" digital TFT color display	
Rear view camera without grid lines	

PACKAGE PRICE (£) **2,910.-**

SAFETY PACK INCL. ACC + 0 kg*

Automatic braking system with pedestrian detection	
Rain and light sensor	
Lane assist	
Traffic sign recognition	
Fatigue detection	
Intelligent speed detection	
Adaptive cruise control >30 km/h	

PACKAGE PRICE (£) **940.-**



* INFO

The factory installation of optional equipment increases the actual mass of the vehicle and reduces the pay-mass. The additional weight indicated for packages and optional equipment shows the additional weight compared to the standard equipment of the respective model or layout. The total weight of the selected optional equipment must not exceed the manufacturer-specified mass for optional equipment

shown in the model overviews. This is a calculated value for each type and layout that Carado uses to determine the maximum weight available for factory-fitted optional equipment. Detailed information and explanations on the subject of weight can be found in the Legal information section.

CARADO ORIGINAL ACCESSORIES* MORE SAFETY WHEN TRAVELING!



With an additional rotary bolt lock for all body doors and a security package with alarm system for windows you can protect your vehicle in the best possible way.

We also offer suitable safes, to keep your valuables safe.

SECURITY PACK WITH ALARM SYSTEM



ARTICLE	SUITABLE FOR SERIES	ART.-NR.	WEIGHT*
Security package / alarm system	Low profile Fiat Coachbuilt Van	3002806	1 kg

SAFES



ARTICLE	SUITABLE FOR SERIES	ART.-NR.	WEIGHT*
Passenger door safe Fiat Ducato (Series 8)	Coachbuilt Camper Van Fiat Van Low profile Fiat	3436402	4,17 kg
Passenger door safe ford	Camper Van Ford Low Profile Ford	8502174	3,45 kg
Floor safe	Low profile Fiat Integrated	2977685	12 kg

Floor safe: Fits T448, T447 Fiat and T447 Ford, I447 and I449.

OSRAM NIGHT BREAKER LED



ARTICLE	SUITABLE FOR SERIES	ART.-NR.	WEIGHT*
Osram Night Breaker LED	Low profile Fiat Coachbuilt Campervan Fiat Van	8502148	0,1 kg

THEFT DETECTION – PROTECT & CONNECT POWERED BY VODAFONE AUTOMOTIVE

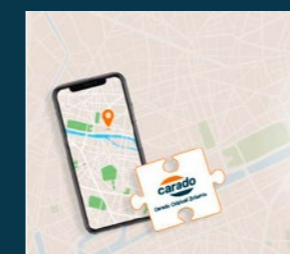

ARTICLE	SUITABLE FOR SERIES	ART.-NR.	WEIGHT*
Theft Tracking – Protect & Connect powered by Vodafone automotive	Low profile Fiat Coachbuilt Campervan Fiat Integrated Van Camper Van Ford Low Profile Ford	3061768	0,21 kg

carado-original-zubehör.com/en

* The items listed in this category are Carado original parts and accessories that are Delivered ex works and not subsequently fitted to the vehicle under the responsibility of the manufacturer become. Original Carado parts and accessories that are subsequently attached to the vehicle affect the payload option and the axle loads. Please note that the technically permissible total mass of the vehicle and the technically permissible total mass on the axle even after the attachment of the original Carado parts and accessories may be exceeded. Further information and explanations on the weight issue can be found in the sales documents and on the manufacturers' website.





INFO



MOTORHOME

OPTIONAL EQUIPMENT

OPTIONAL EXTRAS	PRICE ^{A)}	ADDITIONAL WEIGHT*
 PACKS		
pro+ Pack V132	£4,190.-	83 kg
pro+ Pack V337	£4,280.-	84 kg
pro+ Pack V339	£4,280.-	81 kg
Basic Pack	£570.-	14.6 kg
Optic Pack 1 Painted bumpers	£480.-	3 kg
Optic Pack 2 Alloy wheels	£1,080.-	8 kg
Digital Pack	£2,910.-	4 kg
Safety Pack incl. ACC ¹¹⁾	£940.-	0 kg

 CHASSIS / BASE VEHICLE		
Fiat Ducato 3.500 kg 2.2 Multijet 103 kW 140 BHP Euro 6 8-speed automatic gearbox ¹²⁾	£3,720.-	60 kg
90 l fuel tank	£40.-	23 kg
Fully LED headlights including indicators and LED daytime running lights	£1,170.-	0 kg
Tyre pressure indicator	£360.-	0 kg
Electric parking brake	£550.-	-9.4 kg

 INCREASE OF LOAD CAPACITY		
Weight increase to 3.650 kg (no chassis modification) *	£220.-	0 kg

	V132	V337	V339
pro+ Pack V132	○	—	—
pro+ Pack V337	—	○	—
pro+ Pack V339	—	—	○
Basic Pack	○	○	○
Optic Pack 1 Painted bumpers	○	○	○
Optic Pack 2 Alloy wheels	○	○	○
Digital Pack	○	○	○
Safety Pack incl. ACC ¹¹⁾	○	○	○
Fiat Ducato 3.500 kg 2.2 Multijet 103 kW 140 BHP Euro 6 8-speed automatic gearbox ¹²⁾	○	○	○
90 l fuel tank	○	○	○
Fully LED headlights including indicators and LED daytime running lights	○	○	○
Tyre pressure indicator	○	○	○
Electric parking brake	○	○	○
Weight increase to 3.650 kg (no chassis modification) *	○	○	○

Available in package
 Standard equipment
 Optional equipment
 Mandatory
 Not possible
 Not known at the time of publication
 Notes from page 84

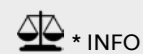

* INFO

The factory installation of optional equipment increases the actual mass of the vehicle and reduces the pay-mass. The additional weight indicated for packages and optional equipment shows the additional weight compared to the standard equipment of the respective model or layout. The total weight of the selected optional equipment must not exceed the manufacturer-specified mass for optional equipment

shown in the model overviews. This is a calculated value for each type and layout that Carado uses to determine the maximum weight available for factory-fitted optional equipment. Detailed information and explanations on the subject of weight can be found in the Legal information section.

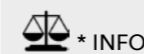

* INFO

The factory installation of optional equipment increases the actual mass of the vehicle and reduces the pay-mass. The additional weight indicated for packages and optional equipment shows the additional weight compared to the standard equipment of the respective model or layout. The total weight of the selected optional equipment must not exceed the manufacturer-specified mass for optional equipment

shown in the model overviews. This is a calculated value for each type and layout that Carado uses to determine the maximum weight available for factory-fitted optional equipment. Detailed information and explanations on the subject of weight can be found in the Legal information section.

OPTIONAL EXTRAS	PRICE ^{A)}	ADDITIONAL WEIGHT*
EXTERIOR SETUP		
Cab sunroof	£450.-	7 kg
Two rear corner steadies	£300.-	6 kg
Bike rack for 3 bikes	£380.-	12.5 kg
2nd external storage door (size depends on layout)	£360.-	3 kg
Insulated waste water tank	£160.-	8 kg

COMFORT		
Bed conversion for seating area ¹³⁾	£310.-	5 kg
Bed conversion single to double bed	£310.-	5 kg
Carpet	£260.-	5 kg
Wooden duckboard for the shower tray	£80.-	2 kg
Folding Cab Blinds	£590.-	8 kg

INSTALLATIONS		
Caramatic SafeDrive PLUS (two-bottle system with gas pressure regulator and crash sensor)	£270.-	3.5 kg
Second AGM leisure battery 95 Ah	£300.-	27 kg
Pre-cabling for reversing camera	£150.-	1 kg
12V TV pre-cabling incl. flat screen holder	£200.-	3 kg
Pre-cabling for solar panel	£150.-	2 kg
Heating Combi 6 E (with el. heating element) incl. digital control panel	£640.-	2 kg
Electric floor heating in living area	£450.-	6 kg
Oven in kitchen	£470.-	12 kg

*** INFO**

The factory installation of optional equipment increases the actual mass of the vehicle and reduces the pay-mass. The additional weight indicated for packages and optional equipment shows the additional weight compared to the standard equipment of the respective model or layout. The total weight of the selected optional equipment must not exceed the manufacturer-specified mass for optional equipment

shown in the model overviews. This is a calculated value for each type and layout that Carado uses to determine the maximum weight available for factory-fitted optional equipment. Detailed information and explanations on the subject of weight can be found in the Legal information section.

	V132	V337	V339
	□	□	□
	○	○	○
	○	○	○
	□	□	●
	□	□	□
	○	-	-
	-	○	-
	○	○	○
	○	○	○
	□	□	□
	○	○	○
	○	○	○
	○	○	○
	○	○	○
	○	○	○
	○	○	○

□ Available in package ● Standard equipment ○ Optional equipment ▲ Mandatory - Not possible ▲ Not known at the time of publication Notes from page 84

*** INFO**

The factory installation of optional equipment increases the actual mass of the vehicle and reduces the pay-mass. The additional weight indicated for packages and optional equipment shows the additional weight compared to the standard equipment of the respective model or layout. The total weight of the selected optional equipment must not exceed the manufacturer-specified mass for optional equipment

shown in the model overviews. This is a calculated value for each type and layout that Carado uses to determine the maximum weight available for factory-fitted optional equipment. Detailed information and explanations on the subject of weight can be found in the Legal information section.

SEMI-INTEGRATED MODEL OVERVIEW

T135



T338



T447



0 1 2 3 4 5 6 7m

TYPE / MODEL	T135	T338	T447
BASIC PRICE INCL. VAT £	61,590.-	64,290.-	65,790.-
PERMITTED NUMBER OF SEATS (INCLUDING DRIVER)*	👤👤👤	👤👤👤	👤👤👤 / + 👤 OPT
BERTHS	👤👤	👤👤 / + 👤 OPT	👤👤 / + 👤👤 OPT
Length Width Height (cm)	594 / 232 / 290	695 / 232 / 290	739 / 232 / 290
Headroom in living area (cm)	195	210	210
Chassis	Fiat Ducato	Fiat Ducato	Fiat Ducato
Standard engine	2.2 Multijet	2.2 Multijet	2.2 Multijet
kW (BHP)	103 (140)	103 (140)	103 (140)
Mass in running order (kg)*	2717 (2581 to 2853)*	2792 (2652 to 2932)*	2896 (2751 to 3041)*
Manufacturer-specified mass for optional equipment (kg)*	437	350	240
Technically permissible maximum laden mass (kg) *	3500	3500	3500
Trailer load braked (unbraked) (kg)	2000 (750)	2000 (750)	2000 (750)
Tyre size	215/70 R 15 CP	215/70 R 15 CP	215/70 R 15 CP
Wheelbase (cm)	345	380	404
Lying area Alcove / pull-down bed (cm)		195 x 140 - 110 OPT	195 x 140 - 110 OPT
Bed dimension middle L x B (cm)			210 x 65 OPT
Bed dimension rear L x B (cm)	200 x 135 - 115	190 x 80 200 x 80 210 x 159 OPT	210 x 80 215 x 80 210 x 168 OPT
Refrigerator volume incl. freezer (l)	78 (11)	78 (11) 156 (29) OPT	78 (11) 156 (29) OPT
Heating type	Combi 6 Gas	Combi 6 Gas	Combi 6 Gas
Fresh water tank capacity total / at driving filling (l)	122 / 20 ¹⁾	122 / 20 ¹⁾	122 / 20 ¹⁾
Waste water tank (l)	92	92	92
Sockets 230 V	5	4	5
Sockets: USB	4	4	4
Inner dimensions storage locker right/left W x H (cm)	65 x 75	95 x 110 75 x 80 OPT	95 x 110 75 x 80 OPT
Gas bottle storage (filling weight in kg)	2 x 11	2 x 11	2 x 11

Configure
your dream
vehicle



OPT Optional ● Standard equipment — Not possible ▲ Not known at the time of publication

⚖️ * INFO

The specified mass in running order is a default value defined in the type-approval procedure. Due to manufacturing tolerances, the actual weighed mass in running order may deviate from the value stated above. Deviations of up to ± 5 % of the mass in running order are legally permissible and possible. The permissible range in kilograms is given in brackets after the mass in running order. The manufacturer-specified mass for optional equipment is a calculated value for each type and layout that Carado uses to determine the maximum weight available for factory-fitted optional equipment. The limitation of optional equipment is intended to ensure that the minimum pay-mass, i.e. the legally prescribed free mass for baggage and retrofitted accessories, is actually available for the vehicle load capacity of the vehicles delivered by Carado. The real weight of your vehicle ex works can only be determined when it is weighed at the

end of the line. If, in exceptional cases, the weighing shows that the actual load capacity falls below the minimum pay-mass despite limiting the optional equipment due to a permissible weight deviation, we will check together with your trade partner and you whether we should, for example, increase the load capacity of the vehicle, reduce the number of seats or remove optional equipment before delivering the vehicle. The technically permissible maximum laden mass of the vehicle and the technically permissible maximum mass on the axle must not be exceeded. Detailed information & explanations on the subject of weight and the configuration of the vehicle can be found in the section Legal information. For a more detailed description of all mandatory technical dependencies, please refer to the explanations on the footnotes.

SEMI-INTEGRATED MODEL OVERVIEW

T448



T457



T459



0 1 2 3 4 5 6 7m

TYPE / MODEL	T448	T457	T459
BASIC PRICE INCL. VAT £	65,790.-	66,090.-	66,090.-
PERMITTED NUMBER OF SEATS (INCLUDING DRIVER)*	👤👤👤👤 / + 👤 OPT	👤👤👤	👤👤👤
BERTHS	👤👤 / + 👤👤 OPT	👤👤 / + 👤👤 OPT	👤👤 / + 👤👤 OPT
Length Width Height (cm)	729 / 232 / 290	739 / 232 / 290	739 / 232 / 290
Headroom in living area (cm)	210	210	210
Chassis	Fiat Ducato	Fiat Ducato	Fiat Ducato
Standard engine	2.2 Multijet	2.2 Multijet	2.2 Multijet
kW (BHP)	103 (140)	103 (140)	103 (140)
Mass in running order (kg)*	2854 (2711 to 2997)*	2911 (2765 to 3057)*	2912 (2766 to 3058)*
Manufacturer-specified mass for optional equipment (kg)*	284	243	221
Technically permissible maximum laden mass (kg) *	3500	3500	3500
Trailer load braked (unbraked) (kg)	2000 (750)	2000 (750)	2000 (750)
Tyre size	215/70 R 15 CP	215/70 R 15 CP	215/70 R 15 CP
Wheelbase (cm)	404	404	404
Lying area Alcove / pull-down bed (cm)	195 x 140 - 110 OPT	195 x 140 - 110 OPT	195 x 140 - 110 OPT
Bed dimension middle L x B (cm)	210 x 100 OPT	210 x 93 OPT	210 x 93 OPT
Bed dimension rear L x B (cm)	205 x 80 210 x 80 210 x 168 OPT	2x 200 x 80 210 x 168 OPT	195 x 150
Refrigerator volume incl. freezer (l)	78 (11) 156 (29) OPT	78 (11) 156 (29) OPT	78 (11) 156 (29) OPT
Heating type	Combi 6 Gas	Combi 6 Gas	Combi 6 Gas
Fresh water tank capacity total / at driving filling (l)	122 / 20 1)	122 / 20 1)	122 / 20 1)
Waste water tank (l)	92	92	92
Sockets 230 V	4	5	5
Sockets: USB	4	4	4
Inner dimensions storage locker right/left W x H (cm)	95 x 110 75 x 80 OPT	95 x 110 75 x 80 OPT	105 x 90 65 x 90
Gas bottle storage (filling weight in kg)	2 x 11	2 x 11	2 x 11

Configure
your dream
vehicle



OPT Optional ● Standard equipment — Not possible ▲ Not known at the time of publication

⚖️ * INFO

The specified mass in running order is a default value defined in the type-approval procedure. Due to manufacturing tolerances, the actual weighed mass in running order may deviate from the value stated above. Deviations of up to ± 5 % of the mass in running order are legally permissible and possible. The permissible range in kilograms is given in brackets after the mass in running order. The manufacturer-specified mass for optional equipment is a calculated value for each type and layout that Carado uses to determine the maximum weight available for factory-fitted optional equipment. The limitation of optional equipment is intended to ensure that the minimum pay-mass, i.e. the legally prescribed free mass for baggage and retrofitted accessories, is actually available for the vehicle load capacity of the vehicles delivered by Carado. The real weight of your vehicle ex works can only be determined when it is weighed at the

end of the line. If, in exceptional cases, the weighing shows that the actual load capacity falls below the minimum pay-mass despite limiting the optional equipment due to a permissible weight deviation, we will check together with your trade partner and you whether we should, for example, increase the load capacity of the vehicle, reduce the number of seats or remove optional equipment before delivering the vehicle. The technically permissible maximum laden mass of the vehicle and the technically permissible maximum mass on the axle must not be exceeded. Detailed information & explanations on the subject of weight and the configuration of the vehicle can be found in the section Legal information. For a more detailed description of all mandatory technical dependencies, please refer to the explanations on the footnotes.

MOTORHOME

STANDARD EQUIPMENT



CHASSIS / BASE VEHICLE

- Fiat Ducato 3.500 kg | 2.2 Multijet | 103 kW | 140 BHP Euro 6 | 6-speed manual gearbox
- Chassis colour white
- Wide-track chassis
- Front wheel drive
- Daytime running lights integrated in headlights
- Headlights with black frame
- Cruise control
- Driver airbag
- Passenger airbag
- ABS | EBD | ESP incl. ABS and Hillholder
- Traction+
- Start & Stop function incl. charge booster
- Multifunction steering wheel
- USB charger (A+C)
- Electric operated cab windows and central locking
- Fix & Go breakdown kit
- Central cup holder
- Comfortable driving experience with rear and front axle stabilizers
- Manual cab air conditioning
- Disc brakes | heat convection | tachometer | power steering | immobiliser | 3-point seat belt
- 15" steel rims
- Tyres M+S Camping (snowflake)
- Electric and heated mirrors
- Radio aerial integrated in mirror
- Captain chairs with covers
- Driver and passenger seats with armrests & upholstered covers
- Driver and passenger seats swivel on Low Profile A-Class models and Overcab A132
- Driver and passenger seat with lumbar support
- Height and tilt adjustable driver and front passenger seats
- 60 l fuel tank
- Radio pre-wiring including speakers



EXTERIOR SETUP

- 7-year water ingress warranty ⁴⁾
- GRP (glass fibre reinforced plastic) roof and rear wall
- Aluminium sidewalls
- Roof and sidewall thickness 34 mm | floor thickness 42,5 mm
- Rear light carrier in three parts with integrated LED multifunction lights
- Double glazed hinged window with cassette blinds and flyscreens (except for bathroom)
- Roof light with frosted perspex glass and flyscreen
- Electric entrance step
- Large rear garage with lowered frame | lashing rings and interior lighting (depending on model)
- Splash water seals for the exterior storage locker and doors
- Payload in garage up to 150 kg
- High quality entrance door with ergonomic handle inside and outside



COMFORT

- Ergonomically shaped upholstery for improved seating comfort
- Isofix for 2 seats
- L-shape lounge with free-standing and rotating table ¹⁴⁾
- Table extension ¹⁵⁾
- High-quality mattress in all beds
- Removable and washable mattress cover
- Wooden slatted frame in all fixed-beds for better sleeping comfort
- Spacious storage compartments and storage options
- Ventilation for storage locker and seat backrest
- Furniture in 'Visby Oak' and 'Sand grey'
- Floor Calais



INSTALLATIONS

- LED lighting integrated above the roof cabinets
- High-performance, maintenance-free leisure battery (95 Ah AGM)
- On-board control panel supplies information about filling levels and battery capacity
- Automatic switching and separating systems for starter and leisure battery as well as for refrigerator
- Electric charger for leisure and vehicle battery 12 V / 18 A
- CEE 230 V external socket with safety device
- Residual Current Device (RCD)
- LED-Awning light
- LED Interior light
- Mirror and coat hooks
- USB Socket 3x A / 1x C (layout depending)
- Fresh water tank capacity total 122 l | waste water tank 92 l



HEATING / GAS SUPPLY

- Gas bottle locker for 2 x 11 kg gas bottles
- Gas control valves easily accessible and centrally arranged
- Gas heating Combi 6



EQUIPEMENT KITCHEN

- Ergonomically arranged kitchen with spacious work top
- Large soft-close drawers in kitchen
- 2 burner hob and glass lid
- Large stainless steel circular sink with cover
- Fridge 78 l with 11 l freezer compartment
- LED light band
- Waste bin
- Flexible railing system with 2 hooks ¹⁶⁾



BATHROOM EQUIPMENT

- Vario-bathroom ¹⁷⁾
- Spacious bathroom with separate shower on the opposite side ¹⁸⁾
- Bathroom with bench toilet and integrated shower cubicle ¹⁹⁾
- Swivel cassette toilet with electric flush ²⁰⁾
- Roof vent with integrated flyscreen blind (depending on model)
- Large mirrors
- Clothes rail in bathroom
- Flexible railing system with two hooks ²¹⁾



SOFT FURNISHING

- Soft furnishing in white

MOTORHOME PACKS

PRO PACK T135 + 48.3 kg*

Optic Pack 1 Painted bumpers	
Optic Pack 2 Alloy wheels	
Basic Pack	
Folding Cab Blinds	
Cab sunroof	
Insulated waste water tank	
pro decals	

PACKAGE PRICE (£) **3,320.-**

PRO PACK T338 & T448 & T447 & T457 + 64.3 kg*

Optic Pack 1 Painted bumpers	
Optic Pack 2 Alloy wheels	
Basic Pack	
Folding Cab Blinds	
Cab sunroof	
Large 156 l fridge with separate 29 l freezer compartment	
Insulated waste water tank	
2nd external storage door (size depends on layout)	
pro decals	

PACKAGE PRICE (£) **3,320.-**

PRO PACK T459 + 61.3 kg*

Optic Pack 1 Painted bumpers	
Optic Pack 2 Alloy wheels	
Basic Pack	
Folding Cab Blinds	
Cab sunroof	
Large 156 l fridge with separate 29 l freezer compartment	
Insulated waste water tank	
pro decals	

PACKAGE PRICE (£) **3,320.-**

PRO+ PACK T135 + 88.5 kg*

Optic Pack 1 Painted bumpers	
Optic Pack 2 Alloy wheels	
Basic Pack	
Artense grey metallic	
Folding Cab Blinds	
Cab sunroof	
Insulated waste water tank	
Awning 3.5 m	
Framed windows	
High-level rear light cluster	
pro+ decals	

PACKAGE PRICE (£) **4,460.-**

▲ Not known at the time of publication



* INFO

The factory installation of optional equipment increases the actual mass of the vehicle and reduces the pay-mass. The additional weight indicated for packages and optional equipment shows the additional weight compared to the standard equipment of the respective model or layout. The total weight of the selected optional equipment must not exceed the manufacturer-specified mass for optional equipment

shown in the model overviews. This is a calculated value for each type and layout that Carado uses to determine the maximum weight available for factory-fitted optional equipment. Detailed information and explanations on the subject of weight can be found in the Legal information section.

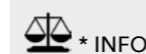

* INFO

The factory installation of optional equipment increases the actual mass of the vehicle and reduces the pay-mass. The additional weight indicated for packages and optional equipment shows the additional weight compared to the standard equipment of the respective model or layout. The total weight of the selected optional equipment must not exceed the manufacturer-specified mass for optional equipment

shown in the model overviews. This is a calculated value for each type and layout that Carado uses to determine the maximum weight available for factory-fitted optional equipment. Detailed information and explanations on the subject of weight can be found in the Legal information section.

PRO+ PACK T338 + 105.8 kg*

Optic Pack 1 Painted bumpers	
Optic Pack 2 Alloy wheels	
Basic Pack	
Artense grey metallic	
Folding Cab Blinds	
Cab sunroof	
Large 156 l fridge with separate 29 l freezer compartment	
Insulated waste water tank	
Awning 4 m	
Framed windows	
High-level rear light cluster	
2nd external storage door (size depends on layout)	
pro+ decals	

PACKAGE PRICE (£) **4,280.-**

PRO+ PACK T447 & T448 & T457 + 109.8 kg*

Optic Pack 1 Painted bumpers	
Optic Pack 2 Alloy wheels	
Artense grey metallic	
Basic Pack	
Folding Cab Blinds	
Cab sunroof	
Large 156 l fridge with separate 29 l freezer compartment	
Insulated waste water tank	
Awning 4.5 m	
Framed windows	
High-level rear light cluster	
2nd external storage door (size depends on layout)	
pro+ decals	

PACKAGE PRICE (£) **4,640.-**

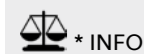

* INFO

The factory installation of optional equipment increases the actual mass of the vehicle and reduces the pay-mass. The additional weight indicated for packages and optional equipment shows the additional weight compared to the standard equipment of the respective model or layout. The total weight of the selected optional equipment must not exceed the manufacturer-specified mass for optional equipment

shown in the model overviews. This is a calculated value for each type and layout that Carado uses to determine the maximum weight available for factory-fitted optional equipment. Detailed information and explanations on the subject of weight can be found in the Legal information section.

PRO+ PACK T459 + 106.8 kg*

Optic Pack 1 Painted bumpers	
Optic Pack 2 Alloy wheels	
Artense grey metallic	
Basic Pack	
Folding Cab Blinds	
Cab sunroof	
Large 156 l fridge with separate 29 l freezer compartment	
Insulated waste water tank	
Awning 4.5 m	
Framed windows	
High-level rear light cluster	
pro+ decals	

PACKAGE PRICE (£) **4,550.-**

BASIC PACK + 14.3 kg*

Panoramic roof light 70 x 50 cm	
Clear glass roof light 40 x 40	
Flyscreen door (one-piece)	
Comfort entrance door	
Bridge Light	

PACKAGE PRICE (£) **950.-**

SAFETY PACK INCL. ACC + 0 kg*

Automatic braking system with pedestrian detection	
Rain and light sensor	
Lane assist	
Traffic sign recognition	
Fatigue detection	
Intelligent speed detection	
Adaptive cruise control >30 km/h	

PACKAGE PRICE (£) **1,520.-**

▲ Not known at the time of publication

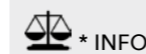

* INFO

The factory installation of optional equipment increases the actual mass of the vehicle and reduces the pay-mass. The additional weight indicated for packages and optional equipment shows the additional weight compared to the standard equipment of the respective model or layout. The total weight of the selected optional equipment must not exceed the manufacturer-specified mass for optional equipment

shown in the model overviews. This is a calculated value for each type and layout that Carado uses to determine the maximum weight available for factory-fitted optional equipment. Detailed information and explanations on the subject of weight can be found in the Legal information section.

DIGITAL PACK + 4 kg*

Automatic cab air conditioning with pollen filter

Wireless smartphone charging

10" radio and navigation system (DAB+)

7" digital TFT color display

Rear view camera without grid lines

PACKAGE PRICE (£)

2,910.-

OPTIC PACK 1 | PAINTED BUMPERS + 3 kg*

Painted bumper

Black glossy skid plate

Fog lights

PACKAGE PRICE (£)

480.-

OPTIC PACK 2 | ALLOY WHEELS + 8 kg*

Leather steering wheel and gear knob in leather trim

Instrument panel with applications (Techno-Trim)

16" alloy wheels two-colour

PACKAGE PRICE (£)

1,080.-



* INFO

The factory installation of optional equipment increases the actual mass of the vehicle and reduces the pay-mass. The additional weight indicated for packages and optional equipment shows the additional weight compared to the standard equipment of the respective model or layout. The total weight of the selected optional equipment must not exceed the manufacturer-specified mass for optional equipment

shown in the model overviews. This is a calculated value for each type and layout that Carado uses to determine the maximum weight available for factory-fitted optional equipment. Detailed information and explanations on the subject of weight can be found in the Legal information section.

CARADO ORIGINAL ACCESSORIES* EVERYTHING IN ITS PLACE!



Discover our Carado Bike Carrier for safe and space-saving bicycle transport in the rear garage.

Use the magnetic board and the accessories for the embedded rails in the vehicle, to create order and maximize storage space.

The pull-out kitchen allows easy access to kitchen utensils, while the pull-out seat keeps your Seating area expanded and valuable storage space created.

BIKE CARRIER



ARTICLE	SUITABLE FOR SERIES	ART.-NR.	WEIGHT*
Bike carrier for 2 Bicycles	Low profile Fiat Coachbuilt Integrated Vans	3143704	6,5 kg
Extension set for bike carriers		3247513	1,5 kg
Wheel shell for wide tires		8502061	0,66 kg

ACCESSORIES FOR THE BALDACCI RAIL

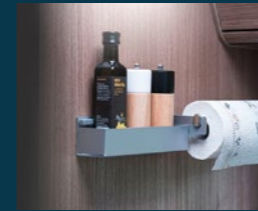

ARTICLE	SUITABLE FOR SERIES	ART.-NR.	WEIGHT*
Hanging hook	Low profile Fiat Integrated Coachbuilt	3105869	0,06 kg
Paper roll holder		3105895	0,29 kg
Spice Rack	Camper Van Fiat	3106155	0,31 kg
Coffee capsule holder	Low Profile Ford	3106160	0,16 kg

KITCHEN EXTENSION



ARTICLE	SUITABLE FOR SERIES	ART.-NR.	WEIGHT*
Kitchen drawer	Low profile Fiat Integrated	3040760	5,6 kg

Kitchen pull-out: Fits the following vehicles only without the oven option: T338 Ford, T447 Ford, T338, T447, T448, all integrated vehicles.

PULL-OUT SEAT



ARTICLE	SUITABLE FOR SERIES	ART.-NR.	WEIGHT*
Seat extension 300 mm	Integrated Low profile Fiat Coachbuilt	3246706	4,1 kg
Seat extension 600 mm		3246710	8 kg

Seat pull-out: Not possible with the 5th seat option.
Seat pull-out 300 mm: Does not fit T338 Fiat and T338 Ford.
Seat pull-out 600 mm: Fits T447 Fiat, T448, T459, I449, I338 and all alcoves.

carado-original-zubehor.com/en



INFO

* The items listed in this category are Carado original parts and accessories that are Delivered ex works and not subsequently fitted to the vehicle under the responsibility of the manufacturer become. Original Carado parts and accessories that are subsequently attached to the vehicle affect the payload option and the axle loads. Please note that the technically permissible total mass of the vehicle and the technically permissible total mass on the axle even after the attachment of the original Carado parts and accessories may be exceeded. Further information and explanations on the weight issue can be found in the sales documents and on the manufacturers' website.



OPTIONAL EXTRAS PRICE ^{A)} ADDITIONAL WEIGHT*

 INCREASE OF LOAD CAPACITY		
Weight increase to 3.650 kg (no chassis modification) *	£220.-	0 kg

 EXTERIOR SETUP		
High-level rear light cluster	£330.-	4 kg
Framed windows	£590.-	5 kg
Insulated waste water tank	£160.-	8 kg
Cab sunroof	£450.-	7 kg
2nd external storage door (size depends on layout)	£360.-	3 kg
Two rear corner steadies	£300.-	6 kg
Bike rack for 3 bikes	£380.-	12.5 kg

 COMFORT		
Bed conversion single to double bed	£310.-	5 kg
Bed conversion for seating area	£310.-	5 kg
Pull-down bed with Clima-Plux elements	£1,440.-	44 kg
5th seat on side bench with seat belt * 22)	£520.-	15 kg
Wooden duckboard for the shower tray	£80.-	2 kg
Carpet	£260.-	5 kg
Folding Cab Blinds	£590.-	8 kg

 * INFO
 The factory installation of optional equipment increases the actual mass of the vehicle and reduces the pay-mass. The additional weight indicated for packages and optional equipment shows the additional weight compared to the standard equipment of the respective model or layout. The total weight of the selected optional equipment must not exceed the manufacturer-specified mass for optional equipment shown in the model overviews. This is a calculated value for each type and layout that Carado uses to determine the maximum weight available for factory-fitted optional equipment. Detailed information and explanations on the subject of weight can be found in the Legal information section.

T135 T338 T447 T448 T457 T459

○	○	○	○	○	○
---	---	---	---	---	---

□	□	□	□	□	□
□	□	□	□	□	□
□	□	□	□	□	□
□	□	□	□	□	□
-	□	□	□	□	●
○	○	○	○	○	○
○	○	○	○	○	○

-	○	○	○	○	-
-	-	○	○	○	○
-	○	○	○	○	○
-	-	○	○	-	-
○	○	○	○	○	○
○	○	○	○	○	○
□	□	□	□	□	□

Available in package
 Standard equipment
 Optional equipment
 Mandatory
 Not possible
 Not known at the time of publication
 Notes from page 84

 * INFO
 The factory installation of optional equipment increases the actual mass of the vehicle and reduces the pay-mass. The additional weight indicated for packages and optional equipment shows the additional weight compared to the standard equipment of the respective model or layout. The total weight of the selected optional equipment must not exceed the manufacturer-specified mass for optional equipment shown in the model overviews. This is a calculated value for each type and layout that Carado uses to determine the maximum weight available for factory-fitted optional equipment. Detailed information and explanations on the subject of weight can be found in the Legal information section.

OPTIONAL EXTRAS

PRICE ^{A)}

ADDITIONAL WEIGHT*



INSTALLATIONS

Large 156 l fridge with separate 29 l freezer compartment	£670.-	13 kg
Oven in kitchen (only in conjunction with 156 l fridge)	£470.-	12 kg
Caramatic SafeDrive PLUS (two-bottle system with gas pressure regulator and crash sensor)	£270.-	3.5 kg
Second AGM leisure battery 95 Ah	£300.-	27 kg
Pre-cabling for solar panel	£150.-	2 kg
Pre-cabling for reversing camera	£150.-	1 kg
12V TV pre-cabling incl. flat screen holder	£200.-	3 kg
Heating Combi 6 E (with el. heating element) incl. digital control panel	£490.-	2 kg
Electric floor heating in living area	£450.-	6 kg



SOFT FURNISHING

Soft furnishing in brown	-	0 kg
--------------------------	---	------

T135

T338

T447

T448

T457

T459

-	□	□	□	□	□
○	○	○	○	○	○
○	○	○	○	○	○
○	○	○	○	○	○
○	○	○	○	○	○
○	○	○	○	○	○
○	○	○	○	○	○
○	○	○	○	○	○
○	○	○	○	○	○

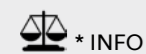

* INFO

The factory installation of optional equipment increases the actual mass of the vehicle and reduces the pay-mass. The additional weight indicated for packages and optional equipment shows the additional weight compared to the standard equipment of the respective model or layout. The total weight of the selected optional equipment must not exceed the manufacturer-specified mass for optional equipment

shown in the model overviews. This is a calculated value for each type and layout that Carado uses to determine the maximum weight available for factory-fitted optional equipment. Detailed information and explanations on the subject of weight can be found in the Legal information section.

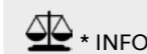

* INFO

The factory installation of optional equipment increases the actual mass of the vehicle and reduces the pay-mass. The additional weight indicated for packages and optional equipment shows the additional weight compared to the standard equipment of the respective model or layout. The total weight of the selected optional equipment must not exceed the manufacturer-specified mass for optional equipment

shown in the model overviews. This is a calculated value for each type and layout that Carado uses to determine the maximum weight available for factory-fitted optional equipment. Detailed information and explanations on the subject of weight can be found in the Legal information section.

□ Available in package ● Standard equipment ○ Optional equipment ▲ Mandatory — Not possible ▲ Not known at the time of publication Notes from page 84

SEMI-INTEGRATED MODEL OVERVIEW

T338 ED25



T447 ED25



T449 ED25



0 1 2 3 4 5 6 7m

TYPE / MODEL	T338 ED25	T447 ED25	T449 ED25
BASIC PRICE INCL. VAT £	75,290.-	77,190.-	77,190.-
PERMITTED NUMBER OF SEATS (INCLUDING DRIVER)*	👤👤👤	👤👤👤 / + 👤 OPT	👤👤👤 / + 👤 OPT
BERTHS	👤 / + 👤👤 OPT	👤 / + 👤👤 OPT	👤 / + 👤👤 OPT
Length Width Height (cm)	699 / 232 / 293	736 / 232 / 293	736 / 232 / 293
Headroom in living area (cm)	210	210	210
Chassis	Ford Transit	Ford Transit	Ford Transit
Standard engine	2,0l TDCi	2,0l TDCi	2,0l TDCi
kW (BHP)	96 (130)	96 (130)	96 (130)
Mass in running order (kg)*	2929 (2783 to 3075)*	2979 (2830 to 3128)*	2986 (2837 to 3135)*
Manufacturer-specified mass for optional equipment (kg)*	217	167	159
Technically permissible maximum laden mass (kg) *	3500	3500	3500
Trailer load braked (unbraked) (kg)	2000 (750)	2000 (750)	2000 (750)
Tyre size	225/75 R 16 CP	225/75 R 16 CP	225/75 R 16 CP
Wheelbase (cm)	375	395	395
Lying area Alcove / pull-down bed (cm)	195 x 140 - 110 OPT	195 x 140 - 110 OPT	195 x 140 - 110 OPT
Bed dimension middle L x B (cm)		210 x 50 OPT	210 x 50 OPT
Bed dimension rear L x B (cm)	192 x 80 200 x 80 210 x 153 OPT	205 x 80 212 x 80 210 x 168 OPT	195 x 150
Refrigerator volume incl. freezer (l)	156 (29) 156 (29)	156 (29) 156 (29)	156 (29) 156 (29)
Heating type	Combi 6 Gas	Combi 6 Gas	Combi 6 Gas
Fresh water tank capacity total / at driving filling (l)	122 / 20 ¹⁾	122 / 20 ¹⁾	122 / 20 ¹⁾
Waste water tank (l)	92	92	92
Sockets 230 V	4	5	5
Sockets: USB	4	4	4
Inner dimensions storage locker right/left W x H (cm)	75 x 110 75 x 80	95 x 110 75 x 80	105 x 90 105 x 90
Gas bottle storage (filling weight in kg)	2 x 11	2 x 11	2 x 11

Configure
your dream
vehicle



OPT Optional ● Standard equipment — Not possible ▲ Not known at the time of publication

⚖️ * INFO

The specified mass in running order is a default value defined in the type-approval procedure. Due to manufacturing tolerances, the actual weighed mass in running order may deviate from the value stated above. Deviations of up to ± 5 % of the mass in running order are legally permissible and possible. The permissible range in kilograms is given in brackets after the mass in running order. The manufacturer-specified mass for optional equipment is a calculated value for each type and layout that Carado uses to determine the maximum weight available for factory-fitted optional equipment. The limitation of optional equipment is intended to ensure that the minimum pay-mass, i.e. the legally prescribed free mass for baggage and retrofitted accessories, is actually available for the vehicle load capacity of the vehicles delivered by Carado. The real weight of your vehicle ex works can only be determined when it is weighed at the

end of the line. If, in exceptional cases, the weighing shows that the actual load capacity falls below the minimum pay-mass despite limiting the optional equipment due to a permissible weight deviation, we will check together with your trade partner and you whether we should, for example, increase the load capacity of the vehicle, reduce the number of seats or remove optional equipment before delivering the vehicle. The technically permissible maximum laden mass of the vehicle and the technically permissible maximum mass on the axle must not be exceeded. Detailed information & explanations on the subject of weight and the configuration of the vehicle can be found in the section Legal information. For a more detailed description of all mandatory technical dependencies, please refer to the explanations on the footnotes.



PACKS

- EDITION25 Pack



HIGHLIGHTS EDITION25

- Chassis colour Chroma blue
- Edition graphics
- 16" alloy wheels (black)
- Insulated waste water tank
- Awning (Length depends on layout)
- Cab sunroof
- Folding Cab Blinds
- Large 156 l fridge with separate 29 l freezer compartment
- 12V TV pre-cabing incl. flat screen holder
- Framed windows
- High-level rear light cluster
- 2nd external storage door (size depends on layout)
- Soft furnishing in grey
- Basic Pack
- Chassis Pack



**CHASSIS /
BASE VEHICLE**

- Ford Transit 3.500 kg | 2,0l TDCi | 96 kW (130 BHP) | Euro 6 | 6-speed manual gearbox
- Wide-track chassis
- Front wheel drive
- Headlights with daytime running lights
- Cruise control
- Driver and passenger airbag
- ABS (anti-lock braking system) | ESC (electronic stability program) | TBC (traction control) | EBD (electronic brake force distribution)
- Hill start assist (crosswind assist | safety brake assist | rollover protection)
- Tyre pressure indicator
- Start & Stop function incl. charge booster
- Electric cab windows
- Central locking cab with remote control
- Radiator grille chrome
- Electric parking brake
- Front parking assistance
- 12" display incl. Apple Car Play & Android Car | four front speakers | DAB antenna | Bluetooth interface | USB port | hands-free system
- Leather steering wheel
- Cup holder driver and passenger side
- Tablet holder and USB port
- Pre-collision assist
- Lane departure warning
- Intelligent speed detection
- Fatigue warning
- Automatic high beam control
- Disc brakes | rear and front wheel stabilisers | heat convection | tachometer | power steering | height-adjustable headlights | immobiliser | lap and diagonal seat belts
- Electric and heated mirrors
- Comfort swivel seats for driver and front passenger, each with 2 armrests and lumbar support
- Height and tilt adjustment for driver and passenger seat
- Driver and passenger seats in matching colours
- Fix & Go breakdown kit
- Rear view camera
- 70 l fuel tank
- Painted bumper



**EXTERIOR
SETUP**

- 7-year water ingress warranty ⁴⁾
- GRP (glass fibre reinforced plastic) roof and rear wall
- Aluminium sidewalls
- Roof and sidewall thickness 34 mm | floor thickness 42,5 mm
- Rear light carrier in three parts with integrated LED multifunction lights
- Double glazed hinged window with cassette blinds and flyscreens (except for bathroom)
- Roof light with frosted perspex glass and flyscreen
- Electric entrance step
- Large rear garage with lowered frame | lashing rings and interior lighting (depending on model)
- Splash water seals for the exterior storage locker and doors
- Payload in garage up to 150 kg
- High quality entrance door with ergonomic handle inside and outside



COMFORT

- Ergonomically shaped upholstery for improved seating comfort
- Isofix for 2 seats
- Table extension
- High-quality mattress in all beds
- Removable and washable mattress cover
- Wooden slatted frame in all fixed-beds for better sleeping comfort
- Spacious storage compartments and storage options
- Ventilation for storage locker and seat backrest
- Furniture in 'Visby Oak' and 'Sand grey'
- Floor Calais



INSTALLATIONS

- LED lighting integrated above the roof cabinets
- High-performance, maintenance-free leisure battery (95 Ah AGM)
- On-board control panel supplies information about filling levels and battery capacity
- Automatic switching and separating systems for starter and leisure battery as well as for refrigerator
- Electric charger for leisure and vehicle battery 12 V / 18 A
- CEE 230 V external socket with safety device
- Residual Current Device (RCD)
- LED-Awning light
- LED Interior light
- Mirror and coat hooks
- USB Socket 3x A / 1x C (layout depending)
- Fresh water tank capacity total 122 l | waste water tank 92 l



**HEATING /
GAS SUPPLY**

- Gas bottle locker for 2 x 11 kg gas bottles
- Gas control valves easily accessible and centrally arranged
- Gas heating Combi 6



**EQUIPEMENT
KITCHEN**

- Ergonomically arranged kitchen with spacious work top
- Large soft-close drawers in kitchen
- 2 burner hob and glass lid
- Large stainless steel circular sink with cover
- LED light band
- Waste bin
- Flexible railing system with 2 hooks ¹⁶⁾
- Large 156 l fridge with separate 29 l freezer compartment



**BATHROOM
EQUIPMENT**

- Vario-bathroom ¹⁷⁾
- Spacious bathroom with separate shower on the opposite side ¹⁸⁾
- Swivel cassette toilet with electric flush
- Roof vent with integrated flyscreen blind (depending on model)
- Large mirrors
- Clothes rail in bathroom
- Flexible railing system with two hooks ²¹⁾



**SOFT
FURNISHING**

- Soft furnishing in grey

MOTORHOME PACKS

BASIC PACK + 14.3 kg*

Panoramic roof light 70 x 50 cm	
Clear glass roof light 40 x 40	
Flyscreen door (one-piece)	
Comfort entrance door	
Bridge Light	

INCLUDED AS STANDARD

CHASSIS PACK + 18 kg*

Manual cab air conditioning	
Fog lights	
Painted bumper	
Headlights with static cornering light	

INCLUDED AS STANDARD

EDITION25 PACK + 110 kg*

Basic Pack	
Chassis Pack	
Chassis colour Chroma blue	
16" alloy wheels (black)	
Folding Cab Blinds	
Cab sunroof	
Large 156 l fridge with separate 29 l freezer compartment	
Insulated waste water tank	
Awning (Length depends on layout)	
Framed windows	
High-level rear light cluster	
2nd external storage door (size depends on layout)	
Edition graphics	
Soft furnishing in grey	

INCLUDED AS STANDARD

ASSISTANCE PACK + 2.6 kg*

Traffic sign recognition	
Adaptive cruise control	
Navigation	
Dual heated and power folding rear view mirrors	

PACKAGE PRICE (£)

1,980.-

△ Not known at the time of publication

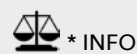

* INFO

The factory installation of optional equipment increases the actual mass of the vehicle and reduces the pay-mass. The additional weight indicated for packages and optional equipment shows the additional weight compared to the standard equipment of the respective model or layout. The total weight of the selected optional equipment must not exceed the manufacturer-specified mass for optional equipment

shown in the model overviews. This is a calculated value for each type and layout that Carado uses to determine the maximum weight available for factory-fitted optional equipment. Detailed information and explanations on the subject of weight can be found in the Legal information section.

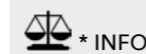

* INFO

The factory installation of optional equipment increases the actual mass of the vehicle and reduces the pay-mass. The additional weight indicated for packages and optional equipment shows the additional weight compared to the standard equipment of the respective model or layout. The total weight of the selected optional equipment must not exceed the manufacturer-specified mass for optional equipment

shown in the model overviews. This is a calculated value for each type and layout that Carado uses to determine the maximum weight available for factory-fitted optional equipment. Detailed information and explanations on the subject of weight can be found in the Legal information section.

MOTORHOME

OPTIONAL EQUIPMENT

OPTIONAL EXTRAS PRICE ^{A)} ADDITIONAL WEIGHT*



PACKS

	PRICE ^{A)}	ADDITIONAL WEIGHT*
Assistance Pack	£1,980.-	2.6 kg



CHASSIS / BASE VEHICLE

Ford Transit 3.500 kg 2,0l TDCi 122 kW (165 BHP) Euro 6 6-speed manual gearbox	£620.-	0 kg
Ford Transit 3.500 kg 2,0l TDCi 122 kW (165 BHP) Euro 6 8-speed automatic gearbox	£3,380.-	55 kg
Bi-xenon headlights with static cornering lights and LED daytime running lights	£680.-	0.2 kg



INCREASE OF LOAD CAPACITY

Ford Transit Maxi Chassis 4.100 kg 2,0l TDCi 122 kW (165 BHP) Euro 6 8-speed automatic gearbox* ²³⁾	£5,980.-	58.5 kg
--	----------	---------



EXTERIOR SETUP

Two rear corner steadies	£320.-	6 kg
Bike rack for 3 bikes	£410.-	12.5 kg

T338 ED25

T447 ED25

T449 ED25

○	○	○
---	---	---

○	○	○
---	---	---

○	○	○
---	---	---

○	○	○
---	---	---

○	○	○
---	---	---

○	○	○
---	---	---

○	○	○
---	---	---

Available in package
 Standard equipment
 Optional equipment
 Mandatory
 Not possible
 Not known at the time of publication
 Notes from page 84



* INFO

The factory installation of optional equipment increases the actual mass of the vehicle and reduces the pay-mass. The additional weight indicated for packages and optional equipment shows the additional weight compared to the standard equipment of the respective model or layout. The total weight of the selected optional equipment must not exceed the manufacturer-specified mass for optional equipment

shown in the model overviews. This is a calculated value for each type and layout that Carado uses to determine the maximum weight available for factory-fitted optional equipment. Detailed information and explanations on the subject of weight can be found in the Legal information section.

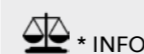

* INFO

The factory installation of optional equipment increases the actual mass of the vehicle and reduces the pay-mass. The additional weight indicated for packages and optional equipment shows the additional weight compared to the standard equipment of the respective model or layout. The total weight of the selected optional equipment must not exceed the manufacturer-specified mass for optional equipment

shown in the model overviews. This is a calculated value for each type and layout that Carado uses to determine the maximum weight available for factory-fitted optional equipment. Detailed information and explanations on the subject of weight can be found in the Legal information section.

 COMFORT		
5th seat on side bench with seat belt * 22)	£560.-	15 kg
Carpet	£280.-	5 kg
Pull-down bed with Clima-Plux elements	£1,560.-	44 kg
Wooden duckboard for the shower tray	£90.-	2 kg
Bed conversion for seating area	£340.-	5 kg
Bed conversion single to double bed	£340.-	5 kg

 INSTALLATIONS		
Caramatic SafeDrive PLUS (two-bottle system with gas pressure regulator and crash sensor)	£290.-	3.5 kg
Second AGM leisure battery 95 Ah	£320.-	27 kg
12V TV pre-cabling incl. flat screen holder	£210.-	3 kg
Heating Combi 6 E (with el. heating element) incl. digital control panel	£540.-	2 kg
Electric floor heating in living area	£490.-	6 kg
Pre-cabling for solar panel	£160.-	2 kg
Oven in kitchen	£520.-	12 kg

	T338 ED25	T447 ED25	T449 ED25
	–	○	○
	○	○	○
	○	○	○
	○	○	○
	–	○	○
	○	○	–
	○	○	○
	○	○	○
	○	○	○
	○	○	○
	○	○	○

 * INFO
 The factory installation of optional equipment increases the actual mass of the vehicle and reduces the pay-mass. The additional weight indicated for packages and optional equipment shows the additional weight compared to the standard equipment of the respective model or layout. The total weight of the selected optional equipment must not exceed the manufacturer-specified mass for optional equipment shown in the model overviews. This is a calculated value for each type and layout that Carado uses to determine the maximum weight available for factory-fitted optional equipment. Detailed information and explanations on the subject of weight can be found in the Legal information section.

 * INFO
 The factory installation of optional equipment increases the actual mass of the vehicle and reduces the pay-mass. The additional weight indicated for packages and optional equipment shows the additional weight compared to the standard equipment of the respective model or layout. The total weight of the selected optional equipment must not exceed the manufacturer-specified mass for optional equipment shown in the model overviews. This is a calculated value for each type and layout that Carado uses to determine the maximum weight available for factory-fitted optional equipment. Detailed information and explanations on the subject of weight can be found in the Legal information section.

INTEGRATED MODEL OVERVIEW

I338

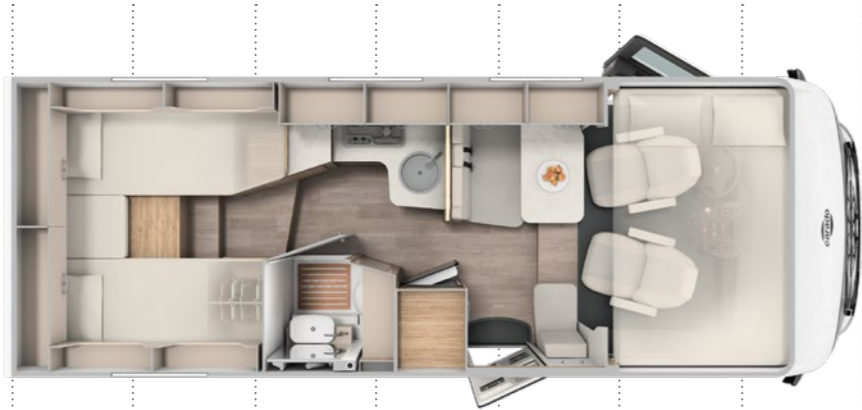

I447



I449



0 1 2 3 4 5 6 7m

TYPE / MODEL	I338	I447	I449
BASIC PRICE INCL. VAT £	75,990.-	78,090.-	78,090.-
PERMITTED NUMBER OF SEATS (INCLUDING DRIVER)*	👤👤👤	👤👤👤 / + 👤 OPT	👤👤👤 / + 👤 OPT
BERTHS	👤👤👤	👤👤👤 / + 👤 OPT	👤👤👤 / + 👤 OPT
Length Width Height (cm)	697 / 232 / 290	740 / 232 / 290	740 / 232 / 290
Headroom in living area (cm)	210	210	210
Chassis	Fiat Ducato	Fiat Ducato	Fiat Ducato
Standard engine	2.2 Multijet	2.2 Multijet	2.2 Multijet
kW (BHP)	103 (140)	103 (140)	103 (140)
Mass in running order (kg)*	2884 (2740 to 3028)*	2961 (2813 to 3109)*	2972 (2823 to 3121)*
Manufacturer-specified mass for optional equipment (kg)*	263	177	166
Technically permissible maximum laden mass (kg) *	3500	3500	3500
Trailer load braked (unbraked) (kg)	2000 (750)	2000 (750)	2000 (750)
Tyre size	215/70 R 15 CP	215/70 R 15 CP	215/70 R 15 CP
Wheelbase (cm)	380	404	404
Lying area Alcove / pull-down bed (cm)	200 x 150	200 x 150	200 x 150
Bed dimension middle L x B (cm)		210 x 65 OPT	210 x 65 OPT
Bed dimension rear L x B (cm)	190 x 80 200 x 80 210 x 159 OPT	210 x 80 215 x 80 210 x 168 OPT	195 x 150
Refrigerator volume incl. freezer (l)	78 (11) 156 (29) OPT	78 (11) 156 (29) OPT	78 (11) 156 (29) OPT
Heating type	Combi 6 Gas	Combi 6 Gas	Combi 6 Gas
Fresh water tank capacity total / at driving filling (l)	122 / 20 1)	122 / 20 1)	122 / 20 1)
Waste water tank (l)	92	92	92
Sockets 230 V	4	5	5
Sockets: USB	4	4	4
Inner dimensions storage locker right/left W x H (cm)	95 x 110 75 x 80 OPT	95 x 110 75 x 80 OPT	105 x 90 65 x 90
Gas bottle storage (filling weight in kg)	2 x 11	2 x 11	2 x 11

Configure
your dream
vehicle



OPT Optional ● Standard equipment — Not possible ▲ Not known at the time of publication

⚖️ * INFO

The specified mass in running order is a default value defined in the type-approval procedure. Due to manufacturing tolerances, the actual weighed mass in running order may deviate from the value stated above. Deviations of up to ± 5 % of the mass in running order are legally permissible and possible. The permissible range in kilograms is given in brackets after the mass in running order. The manufacturer-specified mass for optional equipment is a calculated value for each type and layout that Carado uses to determine the maximum weight available for factory-fitted optional equipment. The limitation of optional equipment is intended to ensure that the minimum pay-mass, i.e. the legally prescribed free mass for baggage and retrofitted accessories, is actually available for the vehicle load capacity of the vehicles delivered by Carado. The real weight of your vehicle ex works can only be determined when it is weighed at the

end of the line. If, in exceptional cases, the weighing shows that the actual load capacity falls below the minimum pay-mass despite limiting the optional equipment due to a permissible weight deviation, we will check together with your trade partner and you whether we should, for example, increase the load capacity of the vehicle, reduce the number of seats or remove optional equipment before delivering the vehicle. The technically permissible maximum laden mass of the vehicle and the technically permissible maximum mass on the axle must not be exceeded. Detailed information & explanations on the subject of weight and the configuration of the vehicle can be found in the section Legal information. For a more detailed description of all mandatory technical dependencies, please refer to the explanations on the footnotes.

MOTORHOME STANDARD EQUIPMENT



CHASSIS / BASE VEHICLE

- Fiat Ducato 3.500 kg | 2.2 Multijet | 103 kW | 140 BHP Euro 6 | 6-speed manual gearbox
- Wide-track chassis
- Front wheel drive
- Cruise control
- Driver airbag
- Passenger airbag
- ABS | EBD | ESP incl. ABS and Hillholder
- Traction+
- Start & Stop function incl. charge booster
- Low vibration, electrical and heated cab mirrors in coach optic with wide angle
- Panoramic laminated glass windshield all-round
- Fix & Go breakdown kit
- Central cup holder
- Manual cab air conditioning
- Multifunction steering wheel
- USB charger (A+C)
- Comfortable driving experience with rear and front axle stabilizers
- Disc brakes | heat convection | tachometer | power steering | immobiliser | 3-point seat belt
- 15" steel rims
- Tyres M+S Camping (snowflake)
- Pilot seats with covers
- Driver and passenger seat with lumbar support
- Driver and passenger seats swivel on Low Profile A-Class models and Overcab A132
- 60 l fuel tank
- Height and tilt adjustable driver and front passenger seats
- Headlamp trim in grey
- Full LED front lighting (daytime running light, low beam, high beam and turn signal)
- Daytime running lights integrated in headlights
- Driver's cab door left
- Radio pre-wiring with loudspeakers and antenna



EXTERIOR SETUP

- 7-year water ingress warranty ⁴⁾
- GRP (glass fibre reinforced plastic) roof and rear wall
- Aluminium sidewalls
- Roof and sidewall thickness 34 mm | floor thickness 42,5 mm
- Rear light carrier in three parts with integrated LED multifunction lights
- Cab blinds for best insulation and privacy shield
- Double glazed hinged window with cassette blinds and flyscreens (except for bathroom)
- Roof light with frosted perspex glass and flyscreen
- Coupé entrance
- Large rear garage with lowered frame | lashing rings and interior lighting (depending on model)
- Splash water seals for the exterior storage locker and doors
- Payload in garage up to 150 kg
- High quality entrance door with ergonomic handle inside and outside



COMFORT

- Ergonomically shaped upholstery for improved seating comfort
- Isofix for 2 seats
- L-shape lounge with free-standing and rotating table ¹⁴⁾
- Table extension ¹⁵⁾
- High-quality mattress in all beds
- Removable and washable mattress cover
- Wooden slatted frame in all fixed-beds for better sleeping comfort
- Pull-down bed with Clima-Plux elements
- Spacious storage compartments and storage options
- Ventilation for storage locker and seat backrest
- Furniture in 'Visby Oak' and 'Sand grey'
- Floor Calais



INSTALLATIONS

- LED lighting integrated above the roof cabinets
- High-performance, maintenance-free leisure battery (95 Ah AGM)
- On-board control panel supplies information about filling levels and battery capacity
- Automatic switching and separating systems for starter and leisure battery as well as for refrigerator
- Electric charger for leisure and vehicle battery 12 V / 18 A
- CEE 230 V external socket with safety device
- Residual Current Device (RCD)
- LED-Awning light
- LED Interior light
- Mirror and coat hooks
- USB Socket 3x A / 1x C (layout depending)
- Fresh water tank capacity total 122 l | waste water tank 92 l



HEATING / GAS SUPPLY

- Gas bottle locker for 2 x 11 kg gas bottles
- Gas heating Combi 6
- Gas control valves easily accessible and centrally arranged



EQUIPEMENT KITCHEN

- Ergonomically arranged kitchen with spacious work top
- Large soft-close drawers in kitchen
- 2 burner hob and glass lid
- Large stainless steel circular sink with cover
- LED light band
- Waste bin
- Flexible railing system with 2 hooks ¹⁶⁾
- Fridge 78 l with 11 l freezer compartment



BATHROOM EQUIPMENT

- Spacious bathroom with separate shower on the opposite side ¹⁸⁾
- Vario-bathroom ¹⁷⁾
- Swivel cassette toilet with electric flush ²⁰⁾
- Roof vent with integrated flyscreen blind (depending on model)
- Large mirrors
- Clothes rail in bathroom
- Flexible railing system with two hooks ²¹⁾



SOFT FURNISHING

- Soft furnishing in white

MOTORHOME PACKS

PRO+ PACKAGE I338 + 89.3 kg*

Basic Pack	
Optic Pack 2 Alloy wheels	
Large 156 l fridge with separate 29 l freezer compartment	
Insulated waste water tank	
Framed windows	
Awning 4.5 m	
High-level rear light cluster	
2nd external storage door (size depends on layout)	
pro+ decals	

PACKAGE PRICE (£) **4,280.-**

PRO+ PACKAGE I447 + 93.3 kg*

Basic Pack	
Optic Pack 2 Alloy wheels	
Large 156 l fridge with separate 29 l freezer compartment	
Insulated waste water tank	
Framed windows	
Awning 5 m	
High-level rear light cluster	
2nd external storage door (size depends on layout)	
pro+ decals	

PACKAGE PRICE (£) **4,460.-**

PRO+ PACKAGE I449 + 90.3 kg*

Optic Pack 2 Alloy wheels	
Basic Pack	
Large 156 l fridge with separate 29 l freezer compartment	
Insulated waste water tank	
Framed windows	
Awning 5 m	
High-level rear light cluster	
pro+ decals	

PACKAGE PRICE (£) **4,460.-**

BASIC PACK + 14.3 kg*

Panoramic roof light 70 x 50 cm	
Clear glass roof light 40 x 40	
Flyscreen door (one-piece)	
Comfort entrance door	
Bridge Light	

PACKAGE PRICE (£) **950.-**

DIGITAL PACK + 4 kg*

Automatic cab air conditioning with pollen filter	
Wireless smartphone charging	
10" radio and navigation system (DAB+)	
7" digital TFT color display	
Rear view camera without grid lines	

PACKAGE PRICE (£) **2,910.-**

OPTIC PACK 2 | ALLOY WHEELS + 8 kg*

Leather steering wheel and gear knob in leather trim	
Instrument panel with applications (Techno-Trim)	
16" alloy wheels two-colour	

PACKAGE PRICE (£) **1,080.-**

▲ Not known at the time of publication

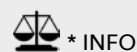

* INFO

The factory installation of optional equipment increases the actual mass of the vehicle and reduces the pay-mass. The additional weight indicated for packages and optional equipment shows the additional weight compared to the standard equipment of the respective model or layout. The total weight of the selected optional equipment must not exceed the manufacturer-specified mass for optional equipment

shown in the model overviews. This is a calculated value for each type and layout that Carado uses to determine the maximum weight available for factory-fitted optional equipment. Detailed information and explanations on the subject of weight can be found in the Legal information section.

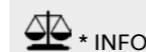

* INFO

The factory installation of optional equipment increases the actual mass of the vehicle and reduces the pay-mass. The additional weight indicated for packages and optional equipment shows the additional weight compared to the standard equipment of the respective model or layout. The total weight of the selected optional equipment must not exceed the manufacturer-specified mass for optional equipment

shown in the model overviews. This is a calculated value for each type and layout that Carado uses to determine the maximum weight available for factory-fitted optional equipment. Detailed information and explanations on the subject of weight can be found in the Legal information section.

MOTORHOME

OPTIONAL EQUIPMENT

OPTIONAL EXTRAS

	PRICE ^{A)}	ADDITIONAL WEIGHT*
 PACKS		
pro+ Package I338	£4,280.-	89.3 kg
pro+ Package I447	£4,460.-	93.3 kg
pro+ Package I449	£4,460.-	90.3 kg
Basic Pack	£950.-	14.3 kg
Digital Pack	£2,910.-	4 kg
Optic Pack 2 Alloy wheels	£1,080.-	8 kg

 CHASSIS / BASE VEHICLE		
Fiat Ducato 3.500 kg 2.2 Multijet 103 kW 140 BHP Euro 6 8-speed automatic gearbox ¹²⁾	£2,870.-	60 kg
90 l fuel tank	£40.-	23 kg
Electric parking brake	£550.-	-9.4 kg
Tyre pressure indicator	£260.-	0 kg

 INCREASE OF LOAD CAPACITY		
Weight increase to 3.650 kg (no chassis modification) *	£220.-	0 kg

 EXTERIOR SETUP		
High-level rear light cluster	£330.-	4 kg
Framed windows	£590.-	5 kg
Insulated waste water tank	£160.-	8 kg
2nd external storage door (size depends on layout)	£360.-	3 kg
Two rear corner steadies	£300.-	6 kg
Bike rack for 3 bikes	£380.-	12.5 kg

I338 I447 I449

○	—	—
—	○	—
—	—	○
○	○	○
○	○	○
○	○	○

○	○	○
○	○	○
○	○	○
○	○	○

○	○	○
---	---	---

□	□	□
□	□	□
□	□	□
□	□	●
○	○	○
○	○	○

□ Available in package ● Standard equipment ○ Optional equipment ▲ Mandatory — Not possible ▲ Not known at the time of publication Notes from page 84

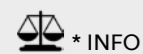

* INFO

The factory installation of optional equipment increases the actual mass of the vehicle and reduces the pay-mass. The additional weight indicated for packages and optional equipment shows the additional weight compared to the standard equipment of the respective model or layout. The total weight of the selected optional equipment must not exceed the manufacturer-specified mass for optional equipment

shown in the model overviews. This is a calculated value for each type and layout that Carado uses to determine the maximum weight available for factory-fitted optional equipment. Detailed information and explanations on the subject of weight can be found in the Legal information section.

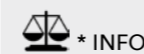



* INFO

The factory installation of optional equipment increases the actual mass of the vehicle and reduces the pay-mass. The additional weight indicated for packages and optional equipment shows the additional weight compared to the standard equipment of the respective model or layout. The total weight of the selected optional equipment must not exceed the manufacturer-specified mass for optional equipment

shown in the model overviews. This is a calculated value for each type and layout that Carado uses to determine the maximum weight available for factory-fitted optional equipment. Detailed information and explanations on the subject of weight can be found in the Legal information section.

OPTIONAL EXTRAS PRICE ^{A)} ADDITIONAL WEIGHT*

	PRICE ^{A)}	ADDITIONAL WEIGHT*
 COMFORT		
Bed conversion single to double bed	£310.-	5 kg
Bed conversion for seating area ²⁴⁾	£310.-	5 kg
5th seat on side bench with seat belt * ²²⁾	£520.-	15 kg
Wooden duckboard for the shower tray	£80.-	2 kg
Carpet	£260.-	5 kg

	PRICE ^{A)}	ADDITIONAL WEIGHT*
 INSTALLATIONS		
Large 156 l fridge with separate 29 l freezer compartment	£670.-	13 kg
Oven in kitchen (only in conjunction with 156 l fridge)	£470.-	12 kg
Caramatic SafeDrive PLUS (two-bottle system with gas pressure regulator and crash sensor)	£270.-	3.5 kg
Second AGM leisure battery 95 Ah	£300.-	27 kg
Pre-cabling for solar panel	£150.-	2 kg
Pre-cabling for reversing camera	£150.-	1 kg
12V TV pre-cabling incl. flat screen holder	£200.-	3 kg
Heating Combi 6 E (with el. heating element) incl. digital control panel	£490.-	2 kg
Electric floor heating in living area	£450.-	6 kg

	PRICE ^{A)}	ADDITIONAL WEIGHT*
 SOFT FURNISHING		
Soft furnishing in brown	-	0 kg

	1338	1447	1449
	○	○	—
	—	○	○
	—	○	○
	○	○	○
	○	○	○
	□	□	□
	○	○	○
	○	○	○
	○	○	○
	○	○	○
	○	○	○
	○	○	○
	○	○	○
	○	○	○
	○	○	○
	○	○	○

 * INFO
 The factory installation of optional equipment increases the actual mass of the vehicle and reduces the pay-mass. The additional weight indicated for packages and optional equipment shows the additional weight compared to the standard equipment of the respective model or layout. The total weight of the selected optional equipment must not exceed the manufacturer-specified mass for optional equipment shown in the model overviews. This is a calculated value for each type and layout that Carado uses to determine the maximum weight available for factory-fitted optional equipment. Detailed information and explanations on the subject of weight can be found in the Legal information section.

 * INFO
 The factory installation of optional equipment increases the actual mass of the vehicle and reduces the pay-mass. The additional weight indicated for packages and optional equipment shows the additional weight compared to the standard equipment of the respective model or layout. The total weight of the selected optional equipment must not exceed the manufacturer-specified mass for optional equipment shown in the model overviews. This is a calculated value for each type and layout that Carado uses to determine the maximum weight available for factory-fitted optional equipment. Detailed information and explanations on the subject of weight can be found in the Legal information section.

□ Available in package ● Standard equipment ○ Optional equipment ▲ Mandatory — Not possible ▲ Not known at the time of publication Notes from page 84

ALCOVES MODEL OVERVIEW

A132 PRO



A361 PRO



A464 PRO



0 1 2 3 4 5 6 7m

TYPE / MODEL	A132 PRO	A361 PRO	A464 PRO
BASIC PRICE INCL. VAT £	62,790.-	66,490.-	71,690.-
PERMITTED NUMBER OF SEATS (INCLUDING DRIVER)*	4	5	5
BERTHS	4	5	5
Length Width Height (cm)	594 / 232 / 314	659 / 232 / 314	724 / 232 / 314
Headroom in living area (cm)	195	195	195
Chassis	Fiat Ducato	Fiat Ducato	Fiat Ducato
Standard engine	2.2 Multijet	2.2 Multijet	2.2 Multijet
kW (BHP)	103 (140)	103 (140)	103 (140)
Mass in running order (kg)*	2837 (2695 to 2979)*	2937 (2790 to 3084)*	3010 (2860 to 3161)*
Manufacturer-specified mass for optional equipment (kg)*	324	46	47
Technically permissible maximum laden mass (kg) *	3500	3500	3500
Trailer load braked (unbraked) (kg)	2000 (750)	2000 (750)	2000 (750)
Tyre size	225/75 R 16 C	225/75 R 16 C	225/75 R 16 C
Wheelbase (cm)	345	380	404
Lying area Alcove / pull-down bed (cm)	210 x 160	210 x 160	210 x 160
Bed dimension middle L x B (cm)		175 x 100	185 x 100
Bed dimension rear L x B (cm)	210 x 140 - 130	210 x 85 205 x 80	210 x 150 - 135
Refrigerator volume incl. freezer (l)	78 (11)	156 (29) 156 (29)	156 (29) 156 (29)
Heating type	Combi 6 Gas	Combi 6 Gas	Combi 6 Gas
Fresh water tank capacity total / at driving filling (l)	122 / 20 ¹⁾	122 / 20 ¹⁾	122 / 20 ¹⁾
Waste water tank (l)	92	92	92
Sockets 230 V	4	5	5
Sockets: USB	4	2	4
Inner dimensions storage locker right/left W x H (cm)	65 x 110 45 x 70	65 x 120 60 x 100	105 x 120 105 x 80
Gas bottle storage (filling weight in kg)	2 x 11	2 x 11	2 x 11

Configure
your dream
vehicle



OPT Optional ● Standard equipment — Not possible ▲ Not known at the time of publication

* INFO

The specified mass in running order is a default value defined in the type-approval procedure. Due to manufacturing tolerances, the actual weighed mass in running order may deviate from the value stated above. Deviations of up to ± 5 % of the mass in running order are legally permissible and possible. The permissible range in kilograms is given in brackets after the mass in running order. The manufacturer-specified mass for optional equipment is a calculated value for each type and layout that Carado uses to determine the maximum weight available for factory-fitted optional equipment. The limitation of optional equipment is intended to ensure that the minimum pay-mass, i.e. the legally prescribed free mass for baggage and retrofitted accessories, is actually available for the vehicle load capacity of the vehicles delivered by Carado. The real weight of your vehicle ex works can only be determined when it is weighed at the

end of the line. If, in exceptional cases, the weighing shows that the actual load capacity falls below the minimum pay-mass despite limiting the optional equipment due to a permissible weight deviation, we will check together with your trade partner and you whether we should, for example, increase the load capacity of the vehicle, reduce the number of seats or remove optional equipment before delivering the vehicle. The technically permissible maximum laden mass of the vehicle and the technically permissible maximum mass on the axle must not be exceeded. Detailed information & explanations on the subject of weight and the configuration of the vehicle can be found in the section Legal information. For a more detailed description of all mandatory technical dependencies, please refer to the explanations on the footnotes.

MOTORHOME

STANDARD EQUIPMENT



PACKS

- pro pack A132
- pro pack A361 & A464
- Basic Pack



CHASSIS / BASE VEHICLE

- Fiat Ducato 3.500 kg | 2.2 Multijet | 103 kW | 140 BHP Euro 6 | 6-speed manual gearbox
- Wide-track chassis
- Front wheel drive
- Daytime running lights integrated in headlights
- Cruise control
- Driver airbag
- Passenger airbag
- ABS | EBD | ESP incl. ABS and Hillholder
- Traction+
- Start & Stop function incl. charge booster
- Electric operated cab windows and central locking
- Multifunction steering wheel
- Fix & Go breakdown kit
- USB charger (A+C)
- Central cup holder
- Manual cab air conditioning
- Comfortable driving experience with rear and front axle stabilizers
- Disc brakes | heat convection | tachometer | power steering | immobiliser | 3-point seat belt
- Radio aerial integrated in mirror
- Headlights with black frame
- Captain chairs with covers
- Driver and passenger seats with armrests & upholstered covers
- Driver and passenger seat with lumbar support
- Driver and passenger seats swivel on Low Profile A-Class models and Overcab A132
- Height and tilt adjustable driver and front passenger seats
- 60 l fuel tank
- Radio pre-wiring including speakers
- Tyres M+S Camping (snowflake)



EXTERIOR SETUP

- 7-year water ingress warranty ⁴⁾
- GRP (glass fibre reinforced plastic) roof and rear wall
- Aluminium sidewalls
- Roof and sidewall thickness 34 mm | floor thickness 42,5 mm
- Rear light carrier in three parts with integrated LED multifunction lights
- Double glazed hinged window with cassette blinds and flyscreens (except for bathroom)
- Roof light with frosted perspex glass and flyscreen
- Electric entrance step
- Large rear garage with lowered frame | lashing rings and interior lighting (depending on model)
- Splash water seals for the exterior storage locker and doors
- Payload in garage up to 150 kg
- High quality entrance door with ergonomic handle inside and outside
- 2nd external storage door (size depends on layout) ²⁵⁾



COMFORT

- Ergonomically shaped upholstery for improved seating comfort
- Isofix for 2 seats
- Table extension ¹⁵⁾
- High-quality mattress in all beds
- Removable and washable mattress cover
- Wooden slatted frame in all fixed-beds for better sleeping comfort
- Overcab with side window on the right | hot air nozzles | 72 cm headroom and 210 x 160 cm bed size
- Sliding overcab bed for an improved access to the cab
- Safety net on overcab beds, bunk beds and on pull-down beds (depending on model)
- Spacious storage compartments and storage options
- Ventilation for storage locker and seat backrest
- Safety Pack: 2 headrests and 2 lap belts on bench against direction of travel (Persons permitted depending on vehicle weight) * ²⁶⁾
- Furniture in 'Visby Oak' and 'Sand grey'
- Bed conversion for seating area
- Floor Calais



INSTALLATIONS

- LED lighting integrated above the roof cabinets
- High-performance, maintenance-free leisure battery (95 Ah AGM)
- On-board control panel supplies information about filling levels and battery capacity
- Automatic switching and separating systems for starter and leisure battery as well as for refrigerator
- Electric charger for leisure and vehicle battery 12 V / 18 A
- CEE 230 V external socket with safety device
- Residual Current Device (RCD)
- LED-Awning light
- LED Interior light
- USB Socket 3x A / 1x C (layout depending)
- Mirror and coat hooks
- Fresh water tank capacity total 122 l | waste water tank 92 l
- Large 156 l fridge with separate 29 l freezer compartment



HEATING / GAS SUPPLY

- Gas bottle locker for 2 x 11 kg gas bottles
- Gas heating Combi 6
- Gas control valves easily accessible and centrally arranged



EQUIPEMENT KITCHEN

- Ergonomically arranged kitchen with spacious work top
- Large soft-close drawers in kitchen
- 2 burner hob and glass lid
- Large stainless steel circular sink with cover
- Fridge 78 l with 11 l freezer compartment
- LED light band
- Waste bin
- Flexible railing system with 2 hooks ¹⁶⁾
- Large 156 l fridge with separate 29 l freezer compartment ²⁶⁾



BATHROOM EQUIPMENT

- Bathroom with separate shower ²⁶⁾
- Vario-bathroom ¹⁷⁾
- Swivel cassette toilet with electric flush
- Roof vent with integrated flyscreen blind (depending on model)
- Large mirrors
- Clothes rail in bathroom



SOFT FURNISHING

- Soft furnishing in brown

MOTORHOME PACKS

PRO PACK A132 + 28 kg*

Optic Pack 1 Painted bumpers	
Optic Pack 2 Alloy wheels	
Basic Pack	
2nd external storage door (size depends on layout)	
pro decals	

INCLUDED AS STANDARD

PRO PACK A361 & A464 + 47 kg*

Optic Pack 1 Painted bumpers	
Optic Pack 2 Alloy wheels	
Basic Pack	
2nd external storage door (size depends on layout)	
Safety Pack: 2 headrests and 2 lap belts on bench against direction of travel (Persons permitted depending on vehicle weight) *	
Large 156 l fridge with separate 29 l freezer compartment	
pro decals	

INCLUDED AS STANDARD

BASIC PACK + 14.3 kg*

Panoramic roof light 70 x 50 cm	
Clear glass roof light 40 x 40	
Flyscreen door (one-piece)	
Comfort entrance door	
Bridge Light	

INCLUDED AS STANDARD



* INFO

The factory installation of optional equipment increases the actual mass of the vehicle and reduces the pay-mass. The additional weight indicated for packages and optional equipment shows the additional weight compared to the standard equipment of the respective model or layout. The total weight of the selected optional equipment must not exceed the manufacturer-specified mass for optional equipment

shown in the model overviews. This is a calculated value for each type and layout that Carado uses to determine the maximum weight available for factory-fitted optional equipment. Detailed information and explanations on the subject of weight can be found in the Legal information section.

VARIANT DIVERSITY

Get to know our different kitchen, bathroom, bed and pack variants. Clever solutions and well-designed room concepts are our mission, and we love to make you feel safe and secure in your motorhome.



CHASSIS

THE BASIS OF THE MOTORHOME

The chassis is the basic framework for every motorhome. Whether it's the wheel suspension, the engine or the home body: all the important components of a motorhome are attached to the chassis, making it the heart of every motorhome.



BEDS

RECREATION ON THE GO

Our comfortable beds not only just invite you to rest, but are also ergonomically thought out. The high-quality mattresses from Carado ensure increased lying comfort, because restful sleep is also very important on vacation. In addition, practical storage and storage options offer plenty of space. Find the right bed for a relaxing trip here.



PACKAGES

AN OPTIMAL ADDITION

With our packages you can easily upgrade your motorhome and give it the finishing touches. From the height-adjustable passenger seat or cruise control to details such as an additional socket in the garage so that the e-bike can be charged quickly - you are guaranteed to find what you are looking for. Discover the clever packages from CARADO so that you can secure numerous advantages.



KITCHEN

THOUGHTFUL CONCEPTS TO ENJOY

Our ergonomically arranged kitchens are perfectly integrated into the living area. Generous work surfaces and a gas cooker with a high-quality glass cover guarantee a lot of flexibility for cooking even in a small space. Standard equipment: spacious servo-soft drawers in the kitchen, LED lighting, spacious refrigerator with optional freezer compartment. Everything to make cooking simply fun.



BATHROOM

FUNCTIONALITY IN A SMALL SPACE

Carados spacious bathrooms offer one thing above all: a functional room concept with maximum comfort for a relaxed start to the day. Whether separate shower room and toilet or combined - generous storage space is available. A cassette toilet with electric pump and rotating seat, large mirror surfaces and many other features are optimally integrated into the room.



SEATING GROUP

COZY LIVING AREA



The living area - there is no place where we come together as often on holiday as here. We play, relax and sometimes just look out of the window.



carado.com/gb/en/our-vehicles/variants

MOTORHOME

OPTIONAL EQUIPMENT

OPTIONAL EXTRAS	PRICE ^{A)}	ADDITIONAL WEIGHT*
 CHASSIS / BASE VEHICLE		
Fiat Ducato 3.500 kg 2.2 Multijet 103 kW 140 BHP Euro 6 8-speed automatic gearbox	£2,870.-	60 kg
90 l fuel tank	£40.-	23 kg
 INCREASE OF LOAD CAPACITY		
Weight increase to 3.650 kg (no chassis modification) *	£220.-	0 kg
 INSTALLATIONS		
Pre-cabling for reversing camera	£150.-	1 kg

A132 PRO	A361 PRO	A464 PRO
○	○	○
○	○	○
○	○	○
○	○	○

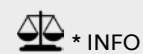

* INFO

The factory installation of optional equipment increases the actual mass of the vehicle and reduces the pay-mass. The additional weight indicated for packages and optional equipment shows the additional weight compared to the standard equipment of the respective model or layout. The total weight of the selected optional equipment must not exceed the manufacturer-specified mass for optional equipment

shown in the model overviews. This is a calculated value for each type and layout that Carado uses to determine the maximum weight available for factory-fitted optional equipment. Detailed information and explanations on the subject of weight can be found in the Legal information section.

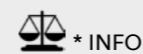

* INFO

The factory installation of optional equipment increases the actual mass of the vehicle and reduces the pay-mass. The additional weight indicated for packages and optional equipment shows the additional weight compared to the standard equipment of the respective model or layout. The total weight of the selected optional equipment must not exceed the manufacturer-specified mass for optional equipment

shown in the model overviews. This is a calculated value for each type and layout that Carado uses to determine the maximum weight available for factory-fitted optional equipment. Detailed information and explanations on the subject of weight can be found in the Legal information section.

Available in package
 Standard equipment
 Optional equipment
 Mandatory
 Not possible
 Not known at the time of publication
 Notes from page 84

NOTES

Technical data as of 01 / 2025, validity from January 1st, 2025

This brochure contains the series status at the time of printing. Despite checking the content, misprints cannot be ruled out. We reserve the right to make equipment changes or product improvements during the course of the model year. Before concluding the contract, please obtain information about the current product and series status from one of our authorized CARADO trading partners.

Some of the vehicles are shown with special equipment.

The information corresponds to the European homologation regulations; These can change up until the vehicle is purchased or delivered. Your CARADO trading partner will be happy to inform you about any changes and the standard scope of delivery.

The tightness guarantee conditions of Carado GmbH apply.

With the publication of this technical data, all previous price lists and brochures lose their validity.

The copyright lies with Carado GmbH. When specifying technical data, possible printing errors and mistakes remain reserved.

FOOTNOTES

- 1 Before driving, please ensure that the fresh water tank does not contain more than 20 l.
- 2 CV540 only available with 140 BHP automatic gearbox.
- 3 CV540
- 4 The water ingress warranty conditions of Carado GmbH apply.
- 5 Shower equipment includes: extendable shower head, shower holder, shower curtain, guide rail. Swivel bath without shower curtain and guide rail.
- 6 Only available in conjunction with automatic transmission, chassis package and digital package. Safety package already included.
- 7 Not possible in conjunction with pre-cabing for solar system.
- 8 Combi 4 Diesel heating for CV601 without digital control panel.
- 9 Not possible in conjunction with pop-top roof.
- 10 For CV540 not possible in conjunction with pop-top roof.
- 11 Only in conjunction with Optic Pack 1| Painted bumpers and Optic Pack 2| Alloy wheels.
- 12 Including 16" steel rims.
- 13 When ordering the option bed conversion of the seating area on the V132, please note that the wardrobe in living room is replaced with a side seat incl. overhead locker.

- 14 For T447, I447, I449.
- 15 Except T447, T457, T459, I447, I449, A361, A464.
- 16 Except T338, T338ED25, I338.
- 17 In A132, T448, T338, T338 ED25 and I338.
- 18 For T447 ED25, T449 ED25, T447, T457, T459, I447, I449.
- 19 In T135.
- 20 Except T135.
- 21 Except T338, T338ED25, T448, I338, A132, A361, A464.
- 22 When ordering the option "5th seat on side bench seat with seat belt", the storage compartment flap inside is omitted. An optional 5th seat must be taken into account when calculating the minimum payload and the mass of the passengers as a regular seat. In order for you to receive the 5th seat, it must be ensured that the minimum payload is still maintained and that all other legal mass values are complied with. Please feel free to contact our trade partners for detailed information.
- 23 For Maxi Chassis the Assistance Pack is included.
- 24 When ordering the option bed conversion of the seating area in the integrated unit the bed entrance is via the side bench.
- 25 Lower window will be omitted on A361.
- 26 A361, A464.

CONTACT

Carado GmbH
Ölmühlestraße 6
88299 Leutkirch im Allgäu

Phone: +49 7561 9097 300
Fac: +49 7561 9097 400

info@carado.com
www.carado.com

A company of the Erwin Hymer Group.

CARADO ORIGINAL ACCESSORIES* MORE COMFORT TO TRAVEL!!



Our Carado water filter clearliQ travel ensures hygienically pure water on the go – reliable, odor and taste neutralizing, and easy to change the filter.

Our outdoor insulating mats offer optimal heat protection in winter and effective sun protection in summer - easy to apply and suitable for any vehicle with a Fiat chassis.

And with our practical cot you can create additional sleeping space in the Fiat vehicle: Easy to assemble, space-saving and with a load capacity of 50 kg ideal for children.

WATER FILTERS CLEARLIQ TRAVEL POWERED BY GRÜNBECK

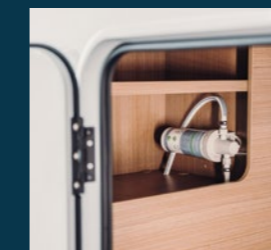

ARTICLE	SUITABLE FOR SERIES	ART.-NR.	WEIGHT*
Water filter clearliQ travel powered by Grünbeck	Low Profile Fiat Coachbuilt	8502066	1,34 kg
Replacement cartridge single pack	Campervan Fiat Integrated Van	8502169	1 kg
Replacement cartridge double pack	Camper Van Ford Low Profile Ford	8502170	1kg (pro Cartridge)

OUTSIDE INSULATION MATS

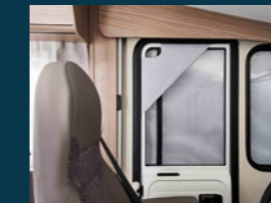

ARTICLE	SUITABLE FOR SERIES	ART.-NR.	WEIGHT*
External insulation	Integrated	8502181	4,1 kg
External insulation	Semi-integrated Camper vans Vans	3333946	3,1 kg

COT



ARTICLE	SUITABLE FOR SERIES	ART.-NR.	WEIGHT*
Cot Fiat variant	Vehicles with original Fiat cab	3542687	10,5 kg

carado-original-zubehör.com/en



INFO

* The items listed in this category are Carado original parts and accessories that are Delivered ex works and not subsequently fitted to the vehicle under the responsibility of the manufacturer become. Original Carado parts and accessories that are subsequently attached to the vehicle affect the payload option and the axle loads. Please note that the technically permissible total mass of the vehicle and the technically permissible total mass on the axle even after the attachment of the original Carado parts and accessories may be exceeded. Further information and explanations on the weight issue can be found in the sales documents and on the manufacturers' website.



LEGAL INFORMATION ON WEIGHT-RELATED INFORMATION

The weight specifications and tests for motorhomes are uniformly regulated throughout the EU in EU Implementing Regulation No. 2021/535 (until June 2022: EU Implementing Regulation No. 1230/2012). We have summarised and explained the key terms and legal requirements from this regulation for you below. Our dealers and the Carado configurator on our website offer you additional assistance in configuring your vehicle.

1. TECHNICALLY PERMISSIBLE MAXIMUM LADEN MASS

The technically permissible maximum laden mass of the vehicle (e.g. 3,500 kg) is a mass specification set by the manufacturer which the vehicle must not exceed. Information on the technically permissible maximum laden mass of the model you have chosen can be found in the technical data. If the vehicle exceeds the technically permissible maximum laden mass in everyday driving, this constitutes an administrative offence which may result in a fine.

2. MASS IN RUNNING ORDER

In simple terms, the mass in running order is the basic vehicle with standard equipment plus a legally fixed standard weight of 75 kg for the driver. This essentially includes the following items:

- the unladen weight of the vehicle together with the bodywork, including operating fluids such as greases, oils and coolants;
- the standard equipment, i.e. all equipment items that are included as standard in the factory-fitted scope of delivery;
- the fresh water tank filled to 100 % in driving mode (driving fill according to manufacturer's specifications; 20 litres) and an aluminium gas cylinder filled to 100 % with a weight of 16 kg;
- the fuel tank, which is 90 % full, including fuel;
- the driver, whose weight – regardless of the actual weight – is generally specified as 75 kg in accordance with EU law.

Information on the mass in running order can be found for each model in our sales documents. It is important to note that the value for mass in running order given in the sales documents is a default value determined in the type-approval procedure and verified by the authorities. It is legally permissible and possible for the mass in running order of the vehicle delivered to you to deviate from the nominal value stated in the sales documents. The legally permissible tolerance is $\pm 5\%$. In this way, the EU legislator accounts for the fact that certain fluctuations in the mass in running order occur due to variations in the weight of supplied parts as well as due to processes and weather conditions. These weight deviations can be illustrated by means of an example calculation:

- Mass in running order acc. to sales documents: 2,850 kg
- Legally permissible tolerance of $\pm 5\%$: 142.50 kg
- Legally permissible range of mass in running order: 2,707.50 kg to 2,992.50 kg

The specific range of permissible weight deviations can be found for each model in the technical data. Carado makes great efforts to reduce weight variations to the minimum that is unavoidable for production reasons. Deviations at the upper and lower end of the range are therefore very rare; however, they cannot be completely ruled out technically, even with all optimisations. The real weight of the vehicle and compliance with the permissible tolerance is therefore checked by Carado by weighing each vehicle at the end of the line.

3. MASS OF THE PASSENGERS

The mass of the passengers is set a standard value of 75 kg for each seat provided by the manufacturer, regardless of the actual weight of the passengers. The mass of the driver is already included in the mass in running order (see no. 2 above) and is therefore not included again. In the case of a motorhome with four permitted seats, the mass of the passengers is therefore $3 \cdot 75 \text{ kg} = 225 \text{ kg}$.

4. OPTIONAL EQUIPMENT AND ACTUAL MASS OF THE VEHICLE

Optional equipment (also: additional equipment) includes, according to the legal definition, all optional equipment parts not included in the standard equipment which are fitted to the vehicle under the responsibility of the manufacturer – i.e. ex works – and can be ordered by the customer (e.g. awning, bicycle or motorbike carrier, satellite system, solar system, oven, etc.). Information on the individual or package weights of the optional equipment that can be ordered can be found in our sales documents. Optional equipment in this sense does not include other accessories that are retrofitted by the dealer or you personally after the vehicle has been delivered ex works.

The mass of the vehicle in running order (see no. 2 above) and the mass of the optional equipment fitted to a specific vehicle at the factory are together referred to as the actual mass. You will find the corresponding information for your vehicle after handover under item 13.2 of the Certificate of Conformity (CoC). Please note that this specification also represents a standardised value. Since the mass in running order – as an element of the actual mass – is subject to a legally permissible tolerance of $\pm 5\%$ (see no. 2), the actual mass may also deviate accordingly from the stated nominal value.

5. PAY-MASS AND MINIMUM PAY-MASS

The installation of optional equipment is also subject to technical and legal limits: Only so much optional equipment can be ordered and fitted at the factory that sufficient free weight remains for baggage and other accessories ("pay-mass") without exceeding the technically permissible maximum laden mass. The pay-mass is calculated by subtracting the mass in running order (nominal value according to sales documents, see no. 2 above), mass of the optional equipment and the mass of the passengers (see no. 3 above) from the technically permissible maximum laden mass (see no. 1 above). The EU regulations stipulate a fixed minimum pay-mass for motorhomes, which must remain as a minimum for baggage or other non-factory-fitted accessories. This minimum pay-mass is calculated as follows:

Minimum pay-mass in kg $\geq 10 \cdot (n + L)$

Where: "n" is the maximum number of passengers plus the driver and "L" is the overall length of the vehicle in metres.

For a motorhome with a length of 6 m and 4 approved seats, the minimum pay-mass is therefore e.g. $10 \text{ kg} \cdot (4 + 6) = 100 \text{ kg}$.

To ensure that the minimum pay-mass is maintained, there is a maximum combination of optional equipment that can be ordered for each vehicle model. In the above example with a minimum pay-mass of 100 kg, the total mass of optional equipment for a vehicle with four permitted seats and a mass in running order of 2,850 kg should not exceed 325 kg:

3.500 kg	technically permissible maximum laden mass
– 2.850 kg	mass in running order
– 3 · 75 kg	mass of the passengers
– 100 kg	minimum pay-mass
= 325 kg	maximum permissible mass of optional equipment

It is important to note that this calculation is based on the default value for mass in running order as defined in the type-approval procedure, without taking into account the permissible weight deviations for mass in running order (see no. 2 above). If the maximum permissible value for the optional equipment of (in the example) 325 kg is almost or completely exhausted, an upward weight deviation can therefore result in the minimum pay-mass of 100 kg being met mathematically using the default value for the mass in running order, although in fact there is no corresponding load capacity. Here, too, an example calculation for a vehicle with four seats, whose real weighed mass in running order is 2 % above the nominal value:

3.500 kg	technically permissible maximum laden mass
– 2.907 kg	real weighed mass in running order (+ 2 % compared to the stated value of 2,850 kg)
– 3 · 75 kg	mass of the passengers
– 325 kg	optional equipment (maximum permissible value)
= 43 kg	actual load capacity (< minimum pay-mass of 100 kg)

In order to avoid such a situation, Carado further reduces the maximum permissible weight of the total optional equipment that can be ordered on a model-specific basis. The limitation of optional equipment is intended to ensure that the minimum pay-mass, i.e. the legally prescribed free mass for baggage and retrofitted accessories, is actually available for the vehicle load capacity of the vehicles delivered by Carado.

Since the weight of a specific vehicle can only be determined when it is weighed at the end of the line, in very rare cases a situation may arise in which the minimum pay-mass at the end of the line is not guaranteed, despite this limitation of optional equipment. In order to guarantee the minimum pay-mass even in these cases, Carado will check together with your trade partner and you before delivery of the vehicle whether, for example, the vehicle is loaded up, seats are reduced or optional equipment is removed.

6. EFFECTS OF TOLERANCES OF THE MASS IN RUNNING ORDER ON THE PAY-MASS

Regardless of the minimum pay-mass, you should note that unavoidable production-related fluctuations in the mass in running order – both upwards and downwards – have a mirror-image effect on the remaining load capacity: If you order our example vehicle (see no. 3. above), for example, with optional equipment with a total weight of 150 kg, the calculated pay-mass based on the default value for the mass in running order is 275 kg. The load capacity actually available may deviate from this value due to tolerances and may be higher or lower. If the mass in running order of your vehicle is, for example, permissibly 2 % higher than stated in the sales documents, the load capacity is reduced from 275 kg to 218 kg:

3.500 kg	technically permissible maximum laden mass
– 2.907 kg	real weighed mass in running order (+ 2 % compared to the stated value of 2,850 kg)
– 3 · 75 kg	mass of the passengers
– 150 kg	optional equipment ordered for the specific vehicle
= 218 kg	Actual load capacity

As a precaution to ensure that the calculated pay-mass is actually given, you should therefore take the possible and permissible tolerances for the mass in running order into account when configuring your vehicle.

We also recommend that you weigh the laden motorhome on a non-automatic scale before each journey and, taking the individual weight of the passengers into account, determine whether the technically permissible maximum laden mass and the technically permissible maximum mass on the axle are observed.



Don't miss
any news.



Sign up for
the newsletter
now!